

Owner's Manual

Water Trailer

340/550 Gallon

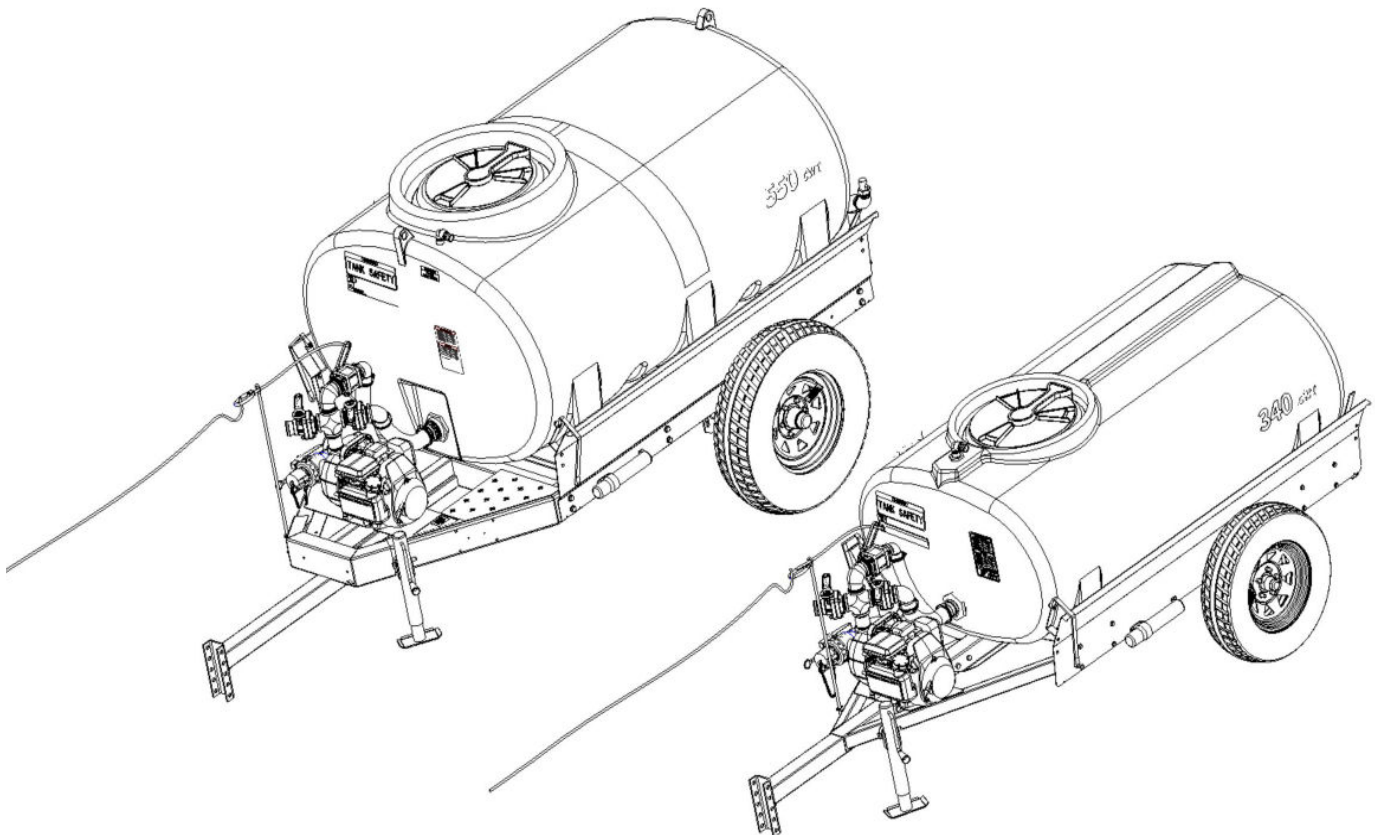

NOTE: This Owner's Manual covers several models. Features may vary by model. Not all features in this manual are applicable to all models and the model depicted may differ from yours.

For Your Records

Located on the front left angled portion of the frame is an ID plate showing the serial number. Record your machine’s information and serial number in the space provided below. ABI will use this information to give you prompt, efficient service when you order parts or need product support.

Model and Serial Number

Model Number:

Serial Number:

Invoice Number:

Purchaser’s Name:

Contact Information

ABI Attachments, Inc
520 S. Byrkit Ave.
Mishawaka, IN 46544

Customer Support

Email: abicutomerservice@abiattachments.com
Phone: 877-788-7253
Website: www.abisupport.com

Table of Contents

Warranty.....	3
Safety.....	4
SafetyLabels.....	7
Uncrating Instructions.....	8
Setup.....	8
Operation Guide.....	10
Specifications.....	15
Basic Operations.....	16
Replacement Parts.....	16
Maintenance.....	17
Trouble Shooting & FAQs.....	19
PartsDescription.....	20
Options.....	51



LIMITED WARRANTY

ABI Water Trailers

36 Month Farm & Ranch, 36 Month Commercial, & 12 Month Rental

TERMS & CONDITIONS

“ABI” means ABI Attachments, Inc. 520 S Byrkit Ave, Mishawaka, Indiana 46544, 877.788.7253. The above referenced models are warrantied for 36 months, from the original invoice date, against defects in materials and/or workmanship when put to normal and designed residential, farm, & ranch consumer use; 36 months for commercial use and 12 months for rental use. This limited warranty is only valid on new equipment to the original purchaser with proof of purchase. Non-transferable.

ABI will coordinate warranty claims for engines and tires and process warranty claims for pumps, tanks, valves, plumbing or other trade components for their respective manufacturers as these items are warranted separately from this limited warranty. The following is a listing of the length of these limited warranty terms; refer to the actual products warranties for details. This listing is not a substitute for or statement of these separate manufacturers warranties. All warranty claims for these components are processed through ABI as stated below. • Honda GX Series Engine: 3 years consumer, 3 Years Commercial • Compact Units: Briggs & Stratton Engine: 2 years consumer, 1 Year Commercial • Compact Units: Honda GC Series Engine: 2 years consumer, 3 Months Commercial • Commercial Pump: Upon discovery of manufacturer confirmed defect • Tanks: Prorated 5 Years • Valves: Upon discovery of manufacturer confirmed defect • Axles: 2 Years • Tires: Down to listed tread remaining - 2 remaining 32nds on highway and 10% remaining 32nds on farm tire.

For the purpose of the warranties of the total frame and overall construction, “normal & designed use” refers to such uses shown in ABI marketing materials, websites, & videos specific to this product and does not include misuse, abuse, accidents, or damage due to inadequate maintenance, storage, or exposure to corrosive materials including airborne salt. However, a final judgment of “normal & designed use” is the sole opinion of ABI.

ABI’s obligation and or liability, under this warranty, of any product defect or claim for injury or damages is limited to repair or replacement of the product, or payment of the reasonable cost of repair or replacement of the product, at ABI’s sole discretion and direction. During the warranty period, warranty replacement parts or replacement product will ship by a standard method at no charge to the warranty holder, in the United States & Canada only. Expedited shipping costs or international shipping costs (Outside of US or Canada) of warranty parts or replacement product is the responsibility of the warranty holder.

To secure warranty service, the warranty holder must, (1) report the defect immediately to ABI customer service, in writing, for warranty consideration within the applicable warranty term and discontinue use of the product; (2) present photographic evidence of the warranty claim and valid proof of purchase; (3) return the product or part to ABI or independent service technician within 30 days of defect discovery or failure, for return, inspection, or repair; if required. If ABI is unable to repair the product to conform to the warranty in a reasonable number of attempts, ABI will provide, at its option, one of the following: (a) a replacement for the product or, (b) a full refund of the purchase price. Repair, replacement, or refunds are the warranty holder’s EXCLUSIVE remedies against ABI under this limited warranty.

ABI IS NOT RESPONSIBLE FOR THE FOLLOWING: (1) Equipment purchased used; (2) Any equipment that has been altered or modified in ways not approved by ABI, including, but not limited to, unauthorized repair, and acts of God; (3) Depreciation or damage caused by normal wear, lack of reasonable and proper maintenance, failure to follow operating instructions/recommendations; misuse, lack of proper protection during storage or use, vandalism, the elements, collision or accident; (4) Normal maintenance/wear parts and/or service, including but not limited to, tips, shanks, teeth, scarifiers, top-links, finish rakes, pins, bolts, leveling blades, profile blades, tires, rims, and bearings. Periodic replacement of normally wearing parts is the responsibility of the warranty holder.

To the extent permitted by law, the limited warranty stated above is the exclusive warranty given by ABI to the original purchaser, and ABI disclaims any other warranties. There are no other warranties, either express or implied, including any warranty of merchantability, fitness for a particular purpose, or arising from course of dealing or trade usage. ABI shall not be liable in any event for incidental or consequential or other special damages under any theory of strict liability or negligence, or expenses of any kind, including, but not limited to, personal injury, damage to property, cost of equipment rentals, loss of profit, loss of time, loss of wages, or cost of hiring services to perform tasks normally performed by this product. ABI reserves the right to make improvements in design or changes in specifications at any time without incurring any obligation to owners of units previously sold. Some jurisdictions do not allow limitations on how long an implied warranty lasts or the exclusion or limitation of incidental or consequential damages, so the above limitations and exclusions may not apply to you. This warranty gives you specific legal rights, and you may also have other rights, which vary from jurisdiction to jurisdiction.

Publish Date: 5/30/2023

Email: support@abiattachments.com

Safety



WARNING! The **SAFETY ALERT SYMBOL** indicates there is a potential hazard to personal safety involved and extra safety precaution must be taken. When you see this symbol, be alert and carefully read the message that follows it. In addition to design and configuration of equipment, hazard control, and accident prevention are dependent upon the awareness, concern, prudence, and proper training of personnel involved in the operation, transport, maintenance, and storage of equipment.



CALIFORNIA PROPOSITION 65

WARNING! Cancer and reproductive harm- www.P65Warnings.ca.gov

SAFETY AT ALL TIMES

Careful operation is your best assurance against an accident. All operators, no matter how much experience they may have, should carefully read this manual and other related manuals, or have the manuals read to them, before operating the tow vehicle and this implement.

- Thoroughly read and understand the “Safety Label” section. Read all instructions noted on them.
- Do not operate the equipment while under the influence of drugs or alcohol as they impair the ability to safely and properly operate the equipment.
- The operator should be familiar with all functions of the tow vehicle and attached implement and be able to handle emergencies quickly.
- Make sure all guards and shields appropriate for the operation are in place and secured before operating implement.
- Keep all bystanders away from equipment and work area.
- Start tow vehicle from the driver’s seat with hydraulic controls in neutral.
- Operate tow vehicle and controls from the driver’s seat only.
- Never dismount from a moving tow vehicle or leave tow vehicle unattended with engine running.
- Do not allow anyone to stand between tow vehicle and implement while backing up to implement.
- Keep hands, feet, and clothing away from power-driven parts.
- While transporting and operating equipment, watch out for objects overhead and along side such as fences, trees, buildings, wires, etc.
- Do not turn tow vehicle so tight as to cause hitched implement to ride up on the tow vehicle’s rear wheel.
- Store implement in an area where children normally do not play. When needed, secure attachment against falling with support blocks.

SAFETY PRECAUTIONS FOR CHILDREN

Tragedy can occur if the operator is not alert to the presence of children. Children generally are attracted to implements and their work.

- Never assume children will remain where you last saw them.
- Keep children out of the work area and under the watchful eye of a responsible adult.
- Be alert and shut the implement and tractor down if children enter the work area.
- Never carry children on the tractor or implement. There is not a safe place for them to ride. They may fall off and be run over or interfere with the control of the tow vehicle.
- Never allow children to operate the tow vehicle or implement, even under adult supervision.
- Never allow children to play on the tow vehicle or implement.
- Use extra caution when backing up. Before the tractor starts to move, look down and behind to make sure the area is clear.

SHUTDOWN & STORAGE

- If engaged, disengage power take-off.
- Park on solid, level ground and lower implement to ground or onto support blocks.
- Put tractor in park or set park brake, turn off engine, and remove switch key to prevent unauthorized starting.
- Relieve all hydraulic pressure to auxiliary hydraulic lines
- Wait for all components to stop before leaving operator’s seat.
- Use steps, grab-handles and anti-slip surfaces when stepping on and off the tractor.
- Detach and store implement in an area where children normally do not play. Secure implement using blocks and supports.

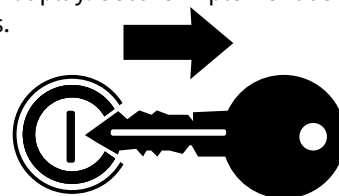

TIRE SAFETY

- Tire changing can be dangerous and must be performed by trained personnel using the correct tools and equipment.
- Always maintain correct tire pressure. Do not inflate tires above recommended pressures shown in the Operator's Manual.
- When inflating tires, use a clip-on chuck and extension hose long enough to allow you to stand to one side and NOT in front of or over the tire assembly. Use a safety cage if available.
- Securely support the implement when changing a wheel.
- When removing and installing wheels, use wheel handling equipment adequate for the weight involved.
- Make sure wheel bolts have been tightened to the specified torque.
- Some attachments may have foam or sealant inside them and must be disposed of properly.

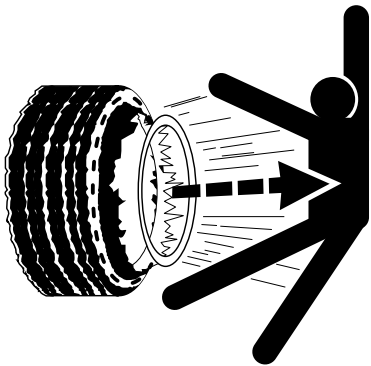

OPERATION SAFETY

- Stay alert for holes, rocks, and roots in the terrain and other hidden hazards. Keep away from drop-offs.
- Stop implement immediately upon striking an obstruction. Turn engine off, remove key, inspect and repair any damage before resuming operation.
- Never operate tractor and implement under trees with low hanging limbs. Operators can be knocked off the tractor and then run over by implement.

TRANSPORT SAFELY

- Comply with federal, state, and local laws.
- Use towing vehicle and trailer of adequate size and capacity. Secure equipment towed on a trailer with tie downs and chains.
- Sudden braking can cause a towed trailer to swerve and upset. Reduce speed if towed trailer is not equipped with brakes.
- Avoid contact with any overhead utility lines or electrically charged conductors.
- Always drive with load on end of loader arms low to the ground.
- Always drive straight up and down steep inclines with heavy end of a tow vehicle with loader attachment on the "uphill" side.
- Engage park brake when stopped on an incline.
- Maximum transport speed for an attached equipment is 20 mph. **DO NOT EXCEED.** Never travel at a speed which does not allow adequate control of steering and stopping. Some rough terrains require a slower speed.
- As a guideline, use the following maximum speed weight ratios for attached equipment:
 - **20 mph** when weight of attached equipment is less than or equal to the weight of machine towing the equipment.
 - **10 mph** when weight of attached equipment exceeds weight of machine towing equipment but not more than double the weight.
- **IMPORTANT:** Do not tow a load that is more than double the weight of the vehicle towing the load.

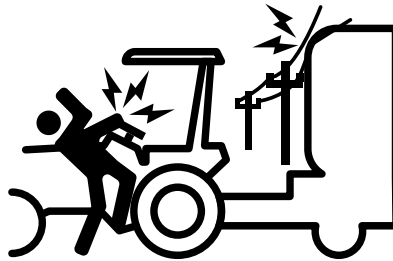

PRACTICE SAFE MAINTENANCE

- Understand procedure before doing work. Refer to the Operator's Manual for additional information.
- Work on a level surface in a clean dry area that is well-lit.
- Lower implement to the ground and follow all shutdown procedures before leaving the operator's seat to perform maintenance.
- Do not work under any hydraulic supported equipment. It can settle, suddenly leak down, or be lowered accidentally. If it is necessary to work under the equipment, securely support it with stands or suitable blocking beforehand.
- Use properly grounded electrical outlets and tools.
- Use correct tools and equipment for the job that are in good condition.
- Allow equipment to cool before working on it.
- Disconnect battery ground cable (-) before servicing or adjusting electrical systems or before welding on implement.
- Inspect all parts. Make certain parts are in good condition & installed properly.
- Replace parts on this implement with genuine ABI Attachments parts only.
- Do not alter this implement in a way which will adversely affect its performance.
- Do not grease or oil implement while it is in operation.
- Remove buildup of grease, oil, or debris.
- Always make sure any material and waste products from the repair and maintenance of the implement are properly collected and disposed.
- Remove all tools and unused parts before operation.



PREPARE FOR EMERGENCIES

- Be prepared if a fire starts.
- Keep a first aid kit and fire extinguisher handy.
- Keep emergency numbers for doctor, ambulance, hospital, and fire department near phone.



USE SAFETY LIGHTS AND DEVICES

- Slow moving tractors, skid steers, self-propelled machines, and towed equipment can create a hazard when driven on public roads. They are difficult to see, especially at night. Use the Slow Moving Vehicle sign (SMV) when on public roads.
- Flashing warning lights and turn signals are recommended whenever driving on public roads.



AVOID UNDERGROUND UTILITIES

- **Dig Safe, Call 811 (USA)** Always contact your local utility companies (electrical, telephone, gas, water, sewer, and others) before digging so that they may mark the location of any underground services in the area.
- Be sure to ask how close you can work to the marks they positioned.



WEAR PERSONAL PROTECTION EQUIPMENT (PPE)

- Wear protective clothing and equipment appropriate for the job such as safety shoes, safety glasses, hard hat, and ear plugs.
- Clothing should fit snug without fringes and pull strings to avoid entanglement with moving parts.
- Prolonged exposure to loud noise can cause hearing impairment or hearing loss. Wear suitable hearing protection such as earmuffs or earplugs.
- Operating equipment safely requires the operator's full attention. Avoid wearing headphones while operating equipment.

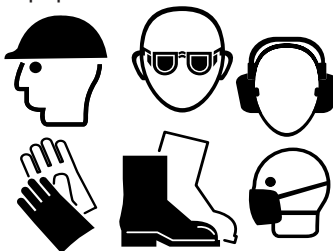

USE SEAT BELT AND ROPS

- ABI Attachments recommends the use of a CAB or roll-over protective structures (ROPS) and seat belt in almost all tow vehicles. Combination of a CAB or ROPS and seat belt will reduce the risk of serious injury or death if the tow vehicle should be upset.
- If ROPS is in the locked-up position, fasten seat belt snugly and securely to help protect against serious injury or death from falling and machine overturn.

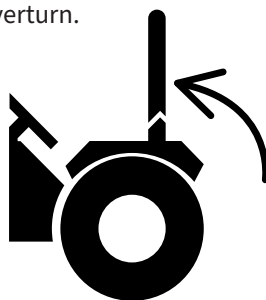

AVOID HIGH PRESSURE FLUIDS HAZARD

- Escaping fluid under pressure can penetrate the skin causing serious injury.
- Before disconnecting hydraulic lines or performing work on the hydraulic system, be sure to release all residual pressure.
- Make sure all hydraulic fluid connections are tight and all hydraulic hoses and lines are in good condition before applying pressure to the system.
- Use a piece of paper or cardboard, NOT BODY PARTS, to check for suspected leaks.
- Wear protective gloves and safety glasses or goggles when working with hydraulic systems.
- **DO NOT DELAY.** If an accident occurs, see a doctor familiar with this type of injury immediately. Any fluid injected into the skin or eyes must be treated within a few hours or gangrene may result.



KEEP RIDERS OFF MACHINERY

- Never carry riders on tractor or implement.
- Riders obstruct operator's view and interfere with the control of the tow vehicle.
- Riders can be struck by objects or thrown from the equipment. Never use tractor or implement to lift or transport riders.

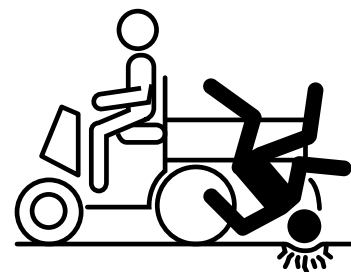

Safety Labels



**WARNING**

10-10978

TO PREVENT SERIOUS INJURY OR DEATH:

- Avoid unsafe operation and maintenance, Do not operate or work on this machine without reading and understanding the operator's manual.
- If manual is lost, call 877-788-7253
- Do not allow riders and keep others away during operation.

- Lower implement, stop tow vehicle engine, set park brake and remove ignition key before servicing, adjusting, repairing or unplugging.
- Safely support and secure implement before adjustments or repairs are made.
- Park or block implement so it will not roll when disconnecting from tow vehicle.

- Never place any part of the body underneath implement or between movable parts even when the engine has been turned off.
- DO NOT operate or transport at high speeds.
- DO NOT operate or transport on steep slopes.

Unpacking Instruction & Setup

Initial Setup Instructions

Tools Needed:

- Gloves
- Safety Glasses
- Safety Shoes
- Tin Snips/ wire cutters
- Hammer
- Crowbar



Removing From Shipping Crate

1. Cut metal straps (Use caution when cutting metal straps that they do not spring toward you and cause injury).
2. Cut and remove Zip-Ties.
3. Remove upper portion of crate but leave wood securing Jack to skid intact until tongue and hitch are assembled.

Initial Setup Instructions

Tools Needed:

- Gloves
- Safety Glasses
- Safety Shoes
- (2) 3/4" wrenches (or socket set)

1. Remove Trailer tongue from frame behind plumbing/engine.
2. Remove (4) 1/2-13 bolts, (8) 1/2" washers and (4) 1/2-13 nuts from box that hitch is packed in.
3. Position Tongue so that the long end of the Tow Bar Adjustment Bracket is facing toward the ground and bolt holes in tongue lined up with bolt holes in frame. Install (1) washer onto all 4 bolts, then insert bolts into frame and tongue. Slide (1) washer onto each bolt then thread nut onto bolt. Tighten nuts using (2) 3/4" wrenches (or sockets).



Leave Jack secured to skid until tongue and hitch are installed.

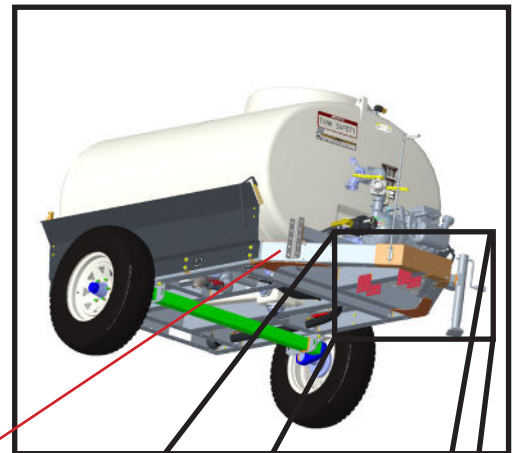

Tongue in shipping position

With tongue in position, install bolts, washers and nuts.

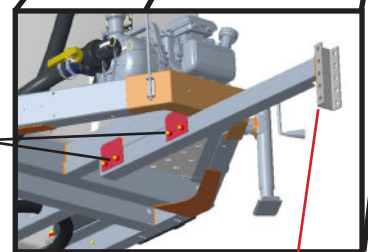

Tongue in position with Tow Bar Adjustment Bracket facing toward ground.

Setup (cont'd)

Hitch Installation to Tow Bar Adjustment Bracket

Tools Needed:

- Gloves
- Safety Glasses
- Safety Shoes
- (2) 15/16" wrenches (or socket set)

There are 3 styles of hitches to choose from. Below are the procedures to mount each one.

Option 1 - P/N 10-10317 - 2 5/16" Ball Hitch Coupler

Slide Ball Hitch Coupler into Tow Bar Adjustment Bracket at desired height. Slide (1) 5/8" washer onto each 5/8-11 x 5" long bolt. Slide the (2) bolts thru holes in bracket and hitch. Slide (1) 5/8" washer onto each bolt then thread 5/8-11 Nylock nuts onto bolts and tighten using (2) 15/16" wrenches or socket set.



Option 2 - P/N 10-90616 - Asm: Hitch Clevis Hitch Pin

Slide Hitch Clevis into Tow Bar Adjustment Bracket at desired height. Slide (1) 5/8" washer onto each 5/8-11 x 5" long bolt. Slide the (2) bolts thru 1st holes in bracket then slide (1) 5/8" washer onto each bolt then continue sliding bolts thru hitch. Slide (1) 5/8" washer onto each bolt then slide bolts thru holes in 2nd bracket. Slide (1) 5/8" washer onto each bolt then thread 5/8-11 Nylock nuts onto bolts and tighten using (2) 15/16" wrenches or socket set.

Place washer on either side of bracket on both bolts.

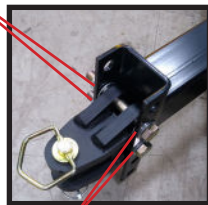

Place washer on either side of bracket on both bolts.

Option 3 - P/N 10-10538 - Hitch - Pentle (Ring Hitch)

Slide Pentle Hitch into Tow Bar Adjustment Bracket at desired height. Slide (1) 5/8" washer onto each 5/8-11 x 5" long bolt. Slide the (2) bolts thru holes in bracket and hitch. Slide (1) 5/8" washer onto each bolt then thread 5/8-11 Nylock nuts onto bolts and tighten using (2) 15/16" wrenches or socket set.

Email: support@abiattachments.com



Once preferred hitch is attached to Tow Bar Bracket, hook water trailer to tow vehicle. Remove wood securing the jack stand to skid. Use hand crank to retract jack stand off the skid. Pull pin securing jack to trailer frame and swivel jack into "stowed" position and replace pin. Pull trailer off skid.

Jack Stand



When water trailer is attached to the tow vehicle, hand crank until jack stand is off the ground. Pull pin and swivel jack up into "stowed" position and replace pin.

Jack MUST be locked in "stowed" position when trailer is hooked to a tow vehicle.

Water Tank Lid

Confirm Tank lid opens correctly:

When closed, locking tabs should line up (Fig 1)

(Recommend securing lid with lock to prevent a child from accidentally falling in). To open, Twist lid counter-clockwise until it stops (locking tabs are NOT aligned) (Fig 2) and open lid. To shut, close lid and twist lid clockwise until it stops (locking tabs will line up).

Locking tabs lined up

Locking tabs NOT lined up



Fig 1.

Fig 2.

Operation Guide

Filling the tank by garden hose

Source valve should be on "Tank Supply" position (end of handle pointing toward tank) as shown in **Fig 3**. On top of the water tank, toward the front is a swivel garden hose connection port (**Fig 4**). Thread Lawn garden hose onto fitting and turn water on. When tank is full, water will automatically stop filling when float in valve is tripped. Turn water supply off and remove garden hose from tank.

Starting Engine

NOTE:

Before starting engine, The pump must be full of water. Fill tank with Garden hose so the water line in tank is at least above the top of the pump (you must remove the cap on top of the pump while filling the tank to bleed the air out of the pump) (see **FIG 5**) - **RUNNING THE PUMP WITHOUT IT BEING FULL OF WATER WILL DAMAGE THE PUMP.**

The pump is full when water seeps out of the top of the pump as you unscrew the cap. Tighten cap after pump is confirmed full. Put valve handles in recommended positions in procedure below (see **Fig 5, 6 & 7**).

- Confirm pump is full of water (**Fig 5**).
- Make sure Source valve handle is in "Tank supply" position (end of handle facing tank) (**Fig 6**).
- Recirculation valve handle 1/4 to fully open (**Fig 6**).
- Close Spray Hose valve handle (**Fig 6**).
- Close rear sprayer valve. There is a silver tab on the valve handle that will turn at 90-degree turns when pull cord is pulled. When the silver tab is perpendicular with the plumbing, the valve is closed (**Fig 8A**). When the silver tab is parallel with the plumbing, the valve is opened (**Fig 8B**).
- Confirm Fuel tank has gasoline (**Fig 7**).
- Confirm the proper amount of oil is in the engine. Oil fill port is located on the backside of the engine (**Fig 9**) (check engine manual for proper oil type for the region you live in).
- Pull out choke (**Fig 7**).
- Move Throttle lever to full position (lever next to "rabbit" symbol) (**Fig 7**).
- Pull engine cord until engine starts then push in choke (**Fig 7**).
- To stop engine, move throttle lever to closed position (lever next to "turtle" symbol (**Fig 7**).

End of Tank Supply handle pointing toward tank.



Fig 3.



Hose Fill

Fig 4.



Pump port

Fig 5A.



Water seepage indicating pump is full of water and free of air

Fig 5B.

Operation Guide (cont'd)

Rear sprayer on/off pull cord

Recirculation valve handle. Handle perpendicular to valve is closed. Handle in line with valve is open.



Fig 6.

Sprayer hose valve handle. Handle perpendicular to valve is closed. Handle in line with valve is open.

Source valve handle facing toward tank

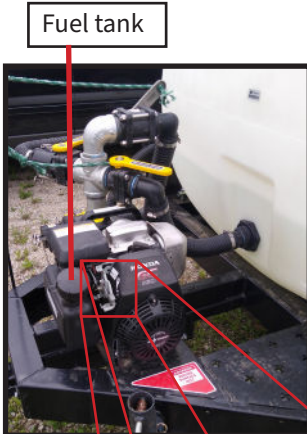

Fig 7A.



Fig 9.

Oil fill port



Fig 7B.

"Rabbit" symbol

"Turtle" symbol

Choke

Throttle Lever

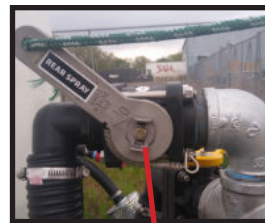

Fig 8A.

Silver tab on valve is perpendicular to plumbing when valve is closed.

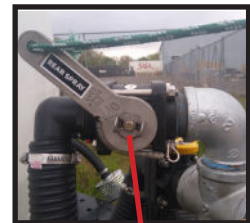

Fig 8B.

Silver tab on valve is parallel to plumbing when valve is opened.

Filling the tank from pond or other water supply with optional Pond Fill Hose

Before filling tank from a pond or external water source, there should be enough water in the tank so that water seeps out of the port on top of the pump when the cap is unscrewed (**Fig 5**). **RUNNING THE PUMP WITHOUT BEING FULL OF WATER WILL DAMAGE THE PUMP.**

The pump is full when water seeps out of the top of the pump as you unscrew the cap. Tighten cap after pump is confirmed full. Put valve handles in recommended positions in procedure below (see **Fig 5, 6 & 7**).

- Confirm pump is full of water (**Fig 5**).
- Remove End Cap from Source valve by unlatching both cam-locks. (**Fig 10**).
- Rotate Source valve handle to "Pond Fill" position (end of handle facing away from tank) (**Fig 11**).
- Unhook Straps securing hoses to tank frame. Lay Pond Fill hose on ground and attach end of pond fill hose to "Pond Fill" valve. Fully seat hose onto valve and secure by closing both cam-locks (**Fig 12**).
- Place other end of Pond Fill hose in pond or some other water source.
- Recirculation valve handle 1/4 to fully open (**Fig 13**).
- Close Spray Hose valve handle (**Fig 13**).
- Close rear sprayer valve. There is a silver tab on the valve handle that will turn at 90-degree turns when pull cord is pulled. When the silver tab is perpendicular with the plumbing, the valve is closed (**Fig 8A**). When the silver tab is parallel with the plumbing, the valve is opened (**Fig 8B**).
- Refer to "Starting Engine" section to start engine.

- When finished Filling tank, rotate source valve handle back to "Tank Fill" position. Stop engine by moving throttle lever to closed position (lever next to "turtle" symbol (**Fig 7**). Remove hose from pond. Unhook hose from valve and replace end cap. Secure end cap to Source valve by latching both cam-locks. Strap hose back onto water trailer frame (**Fig 14**).



Fig 10.



Fig 11.

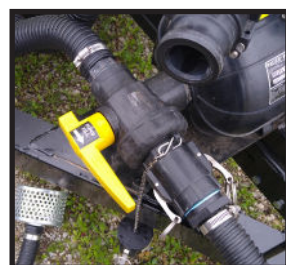

Fig 12.



Fig 14.

Recirculation valve handle. Handle perpendicular to valve is closed. Handle in line with valve is open.

Rear sprayer on/off pull cord

Fig 13.



Sprayer hose valve handle. Handle perpendicular to valve is closed. Handle in line with valve is open.

Source valve handle facing away from tank.

Using Spray hose

- Confirm pump is full of water.
Before starting the engine, there should be enough water in the tank so that water seeps out of the port on top of the pump when the cap is unscrewed (**Fig 5**). **RUNNING THE PUMP WITHOUT BEING FULL OF WATER WILL DAMAGE THE PUMP.** The pump is full when water seeps out of the top of the pump as you unscrew the cap. Tighten cap after pump is confirmed full.
- Confirm Source valve handle is in "Tank Supply" position (end of handle facing toward tank) (**Fig 6**).
- Unhook Straps securing hoses to tank frame. Lay Spray hose on ground and attach end of spray hose to "Spray Hose" valve (Spray hose handle on valve should be closed at this time). Fully seat hose onto valve and secure by closing both cam-locks (**Fig 15**).
- Recirculation valve handle 1/4 to fully open (**Fig 6**).
- Close rear sprayer valve. There is a silver tab on the valve handle that will turn at 90-degree turns when pull cord is pulled. When the silver tab is perpendicular with the plumbing, the valve is closed (**Fig 8A**). When the silver tab is parallel with the plumbing, the valve is opened (**Fig 8B**).
- Refer to "Starting Engine" section to start engine.
- TO AVOID POSSIBLE INJURY,** Grab hold of spray hose by nozzle before turning spray hose handle on valve to "open" position. Turn spray hose handle on valve to fully "open" position (**Fig 16**).
- While using spray hose, regulate the water pressure by adjusting the Recirculation valve handle. When Recirculation valve handle is fully closed, more water pressure will come out the spray hose nozzle. The more fully open the Recirculation valve handle is, less water pressure will come out the spray hose nozzle (**Fig 17**).
- Adjust the spread of the water coming out of the spray hose nozzle by twisting the end of the nozzle. Twisting the end of the nozzle clockwise creates a tighter spray stream. Twisting the end of the nozzle counter-clockwise widens the spray stream (**Fig 18**).
- When finished spraying, turn spray valve handle to "closed" position (**Fig 15**). Stop engine by moving throttle lever to closed position (lever next to "turtle" symbol (**Fig 7**). Make sure Recirculation valve handle is at least 1/4 to fully open position. Unhook hose from valve. Strap hose back onto water trailer frame.

Operation Guide (cont'd)

CAUTION:

Do not let your tank go empty when spraying. RUNNING THE PUMP WITHOUT BEING FULL OF WATER WILL DAMAGE THE PUMP.



Cam-locks to secure spray hose to valve - fully seat hose onto valve before latching cam-locks.

Fig 15.



Fig 16A.



Fig 16B.



Fig 17.



Fig 18.

Storing Spray hose

There are brackets on each corner of the trailer. The front two brackets have bungee cords. Disconnect Spray hose from Spray hose valve. Wrap Spray hose around tank with the hose inside the brackets. Pull both bungee cords over the top of hose and hook to lower edge of trailer side panel.

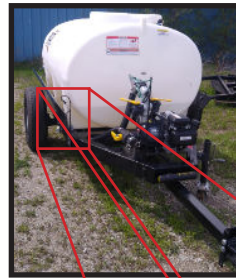

Wrap Spray hose around tank inside the brackets on each corner. Secure hose in both front corners with bungee cords.

Using Rear Sprayer

- Confirm pump is full of water.
Before starting the engine, there should be enough water in the tank so that water seeps out of the port on top of the pump when the cap is unscrewed (**Fig 5**). **RUNNING THE PUMP WITHOUT BEING FULL OF WATER WILL DAMAGE THE PUMP.** The pump is full when water seeps out of the top of the pump as you unscrew the cap. Tighten cap after pump is confirmed full.
- Confirm Source valve handle is in "Tank Supply" position (end of handle facing toward tank) (**Fig 6**).
- Recirculation valve handle 1/4 to fully open (**Fig 6**).
- Sprayer hose valve handle is in "closed" position (**Fig 6**).
- Close rear sprayer valve. There is a silver tab on the valve handle that will turn at 90-degree turns when pull cord is pulled. When the silver tab is perpendicular with the plumbing, the valve is closed (**Fig 8A**). When the silver tab is parallel with the plumbing, the valve is opened (**Fig 8B**).
- Refer to "Starting Engine" section to start engine.
- Pull rear spray valve cord and release to start water flow (**Fig 19**).
- While using the rear sprayer, regulate the water pressure by adjusting the Recirculation valve handle. When Recirculation valve handle is fully closed, more water pressure will come out the rear sprayer. The more fully open the Recirculation valve handle is, less water pressure will come out the rear sprayer (**Fig 17**).
- When finished spraying, pull rear sprayer cord and release to stop water flow (**Fig 19**). Stop engine by moving throttle lever to closed position (lever next to "turtle" symbol (**Fig 7**). Make sure Recirculation valve handle is at least 1/4 to fully open position.

CAUTION:

Do not let your tank go empty when spraying. RUNNING THE PUMP WITHOUT BEING FULL OF WATER WILL DAMAGE THE PUMP.



Fig 19.

Rear sprayer pull cord

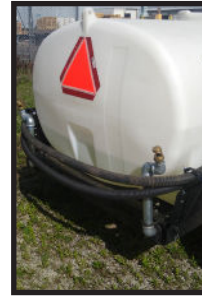

Draining your tank

- Drain port and valve are located under the trailer frame in front of the right tire.
 - Turn drain valve handle 90 degrees counter-clockwise to open. Once tank is empty, Turn drain valve handle 90 degrees clockwise to close (**Fig 20**).
- If draining for storage and or freezing conditions,
- drain water out of pump by opening drain port on underside of pump. Once empty, retighten drain port. (**Fig 21**).

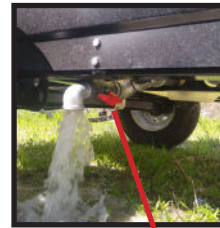

Fig 20A.

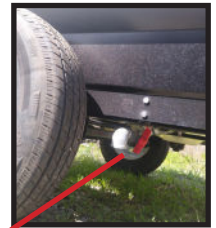

Fig 20B.

Tank drain valve

Pump drain port



Fig 21.

- If complete tank drainage is desired, remove drain plug on underside of tank).



Drain Plug on underside of water tank (550 option only)

Specifications

COMPONENT	DESCRIPTION	
Tank Capacity	340 Gallons	550 Gallons
Empty Weight	661 lbs	1200 lbs
Unit Weight With Tank Full	3498 lbs	5800 lbs
Unit Length	134"	141"
Unit Width	64"	79"
Unit Height	52"	68"
Min. Tractor H.P. (Level Terrain)	24 H.P. 4WD	35 H.P. 4WD
Frame Construction	Welded Tube Steel 2-1/2" Tall X 31-1/2" Wide x 1/4" Thick	Welded Channel Steel 5" Tall X 3" Wide x 3/16" Thick
Ground Clearance	10"-11" at Hitch and Wheels	Wall 12" At Wheels - 8" At Hitch
# of Tires	2 (Two)	2 (Two)
Tires	Tire Size: ST205/75R14D	Tire Size: ST255/80R16E
Rims	14" Diameter x 5 1/2" Wide	16" Diameter x 7 1/2" Wide
Hitch Type	Optional: 2 5/16" Ball or 5/8" Pin or Pentle	Optional: 2 5/16" Ball or 5/8" Pin or Pentle
Hitch Height	Adjustable From 11-3/4" -21"	Adjustable From 8.5" -17"
Tank Type	Elliptical Rotationally Molded	Elliptical Rotationally Molded
Tank Color	White	White
Tank Drainage	Full Drain	Full Drain
Tanks Top Opening	16 " around with vented lid	16 " around with vented lid
# of Spray Nozzles	1 (One)	2 (Two)
Rear Nozzle Type	Brass - Flooding, 1" NPT	Brass - Flooding, 1" NPT
Spray Coverage	around 3' -12'	6' - 20'
Motor Brand	Honda	Honda
Motor Power	160cc Displacement 6.9 lb-ft Torque Net, 4.6 HP Net	160cc Displacement 6.9 lb-ft Torque Net, 4.6 HP Net
Pump Brand	Pacer	Pacer
Pump Construction	2" Polypropylene	2" Polypropylene
Priming	Self-Priming	Self-Priming
Spray Hose	Standard	Standard
Quick Fill System	Optional	Optional
D.O.T. Compliant	No	No

Basic Operations

INDOOR	WEEKLY	OUTDOOR	WEEKLY
80' X 100'	50-800 GAL.	60' ROUND	800-1200 GAL.
100' X 150'	1000-1500 GAL.	150' X 200'	2000-3000 GAL.
150' X 200'	1500-3000 GAL.	180' X 300'	4000-5000 GAL.

Numbers are averages. Footing, drainages and climate will determine proper application for a specific arena.

340 GALLON

REAR SPRAY SYSTEM

RECIRCULATION VALVE SETTINGS	FLOW RATE GPM	MINS. TO EMPTY FROM FULL
Valve Fully Open	49	6:15
Valve 3/4 Open	54	5:45
Valve 1/2 Open	62	5:00
Valve 1/4 Open	80	4:00
Valve Fully Closed	86	3:30

SPRAY HOSE

RECIRCULATION VALVE SETTINGS	FLOW RATE GPM	MINS. TO EMPTY FROM FULL
Valve Fully Open	31	10:00
Valve 3/4 Open	33	9:15
Valve 1/2 Open	39	8:00
Valve 1/4 Open	45	7:00
Valve Fully Closed	47	6:30

RECIRCULATION VALVE

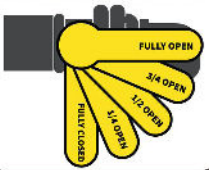

WWW.ABIATTACHMENTS.COM
877-788-7253
WWW.ABISUPPORT.COM
PROUDLY MANUFACTURED IN THE USA

*Approximate time and GPM shown. Your results may vary.

550 GALLON

REAR SPRAY SYSTEM

RECIRCULATION VALVE SETTINGS	FLOW RATE GPM	MINS. TO EMPTY FROM FULL
Valve Fully Open	43	12:00
Valve 3/4 Open	68	7:45
Valve 1/2 Open	90	5:45
Valve 1/4 Open	104	5:00
Valve Fully Closed	115	4:30

SPRAY HOSE

RECIRCULATION VALVE SETTINGS	FLOW RATE GPM	MINS. TO EMPTY FROM FULL
Valve Fully Open	21	25:15
Valve 3/4 Open	27	19:15
Valve 1/2 Open	39	13:15
Valve 1/4 Open	46	11:15
Valve Fully Closed	49	10:30

RECIRCULATION VALVE

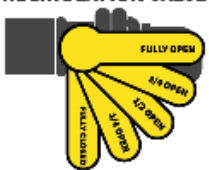

WWW.ABIATTACHMENTS.COM
877-788-7253
WWW.ABISUPPORT.COM
PROUDLY MANUFACTURED IN THE USA

*Approximate time and GPM shown. Your results may vary.

Maintenance

Lubricating Wheel Hubs

The grease zerk to lube the bearing hub is located behind the rubber cap in the center of the hub. Pull off the rubber cap and pack the bearing full of grease then put the rubber cap back on. The bearing in each of the hubs should be greased every 6 months. They should also be greased before any long period of storage. (**Fig 22**).

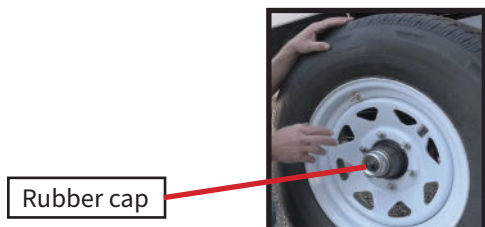

Fig 22A.



Fig 22B.

Tire Pressure:

Tire pressure should be 65 psi (cold) on the 340 Gal and 80 psi (cold) on the 550 Gal. Check pressure once a month or if tire visually looks low. Fill with air if low.

Lug Nut Torque Spec:

Lug nuts should be torques to 90 ft/lbs. Check lug nuts once a month.

Pump/Engine:

Refer to the manuals provided by the pump and engine manufacturer for maintenance instructions for the respective components. This can be located in the document holder connected to the frame on the front of the Water Trailer (**Fig 23**).

- Never run the Motor and Pump for long periods of time without water in the system. Operating the Pump and Motor while the system is empty may result in damage to the Pump seals or impeller. When the Water Trailer is empty shut off the Motor to prevent any damage to the Pump and Motor.
- Always use a gas stabilizer in the gas used in the engine for the Water Trailer. Failure to use gas stabilizer in the fuel may result in issues with the engine functionality.
- Always follow Manufacturer suggested maintenance requirements and manufacturer recommendations for any replacement parts.
- Check oil level before any use to ensure the oil level is at proper operational levels. See Manufacturers guide for information on oil types and levels.



Fig 23.

Manual/Instructions
document holder

Winterizing Preparation:

The drain port and valve are located under the trailer frame in front of the right tire (**Fig 24**). Turn drain valve handle 90 degrees counter-clockwise to open. Turn drain valve handle 90 degrees clockwise to close when tank has 1 to 2 gallons of water left in it.

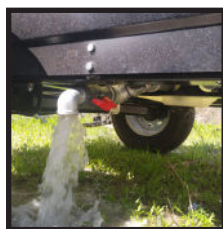

Fig 24A.

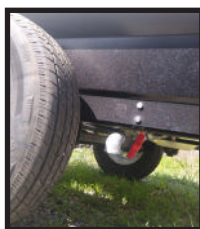

Fig 24B.

Pour 2 to 4 gallons of pink RV antifreeze into tank. Confirm spray hose valve and rear sprayer valve are closed. Confirm source valve handle is in "Tank Supply" position. Confirm Recirculation valve handle is in open position. Start engine and let water circulate thru the system a few minutes then open rear sprayer valve and let some antifreeze spray thru the rear sprayer nozzles then close rear sprayer valve. Open the spray hose valve for a few seconds to allow some antifreeze to run thru the valve then close valve. Turn the Source valve handle to "Pond Fill" then back to "Tank Supply" position. Shut engine off. There is lubrication in the antifreeze. Running antifreeze thru the system and valves will lubricate the seals within the valves and add longer life to the valves.

Maintenance (cont'd)

Winterizing Preparation (cont'd):

Leave about 2 gallons of the RV Antifreeze in the tank to store for winter.

*** Failure to properly Winterize/Freeze Protect your Water Trailer may result in damage to the Water Trailer components that may not be covered by Manufacturer Warranty. Be sure to properly flush already winterized units before use.***

Fuel Tank Preparation for prolong storage:

To prevent the fuel from breaking down and or gumming up the carburator from sitting for a prolong time, it's recommended to drain the fuel from the tank. If the fuel tank is almost empty, start the engine and let it run until it runs out of gas. If the fuel tank is mostly full, drain the tank by unhooking the fuel line hose from the underside of the tank and let the fuel drain out into a container then reattach the fuel line. Start the engine to burn out the remaining gas in the carburator (**Fig 25**).

Squeeze fuel line clamp with pliers and pull fuel line off and drain fuel into container. Reattach hose by squeezing clamp with pliers and slide fuel line back onto barb fitting with clamp being in it's original position.



Fig 25.

Replacement Parts

1. All of the ground engaging components are considered wear parts and will need to be replaced as they wear out from use. To reorder, please contact the ABI Support department at 877-788-7253.

2. In the event the water trailer lid gets damaged, 10-11233 LID W/BRKT: WATER TRAILER TANK, 340/550 GAL can be ordered. Use the existing hardware when replacing the lid onto the water tank.

Apply thick ring of silicone around the entire mounting surface before mounting lid to water tank.

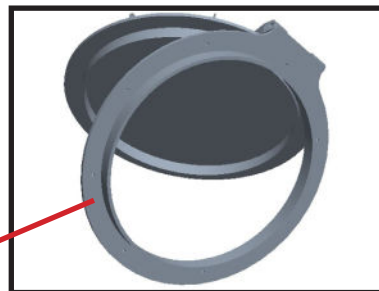
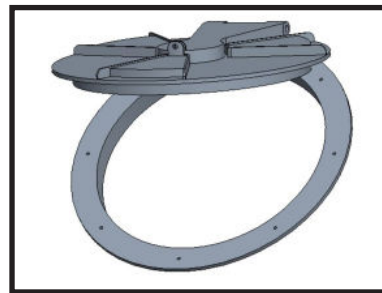

Apply thick ring of silicone around this entire surface before mounting lid to water tank.

Troubleshooting & FAQs

Ratcheting Valve on Rear Sprayer Information:

The Ratcheting Valve works on a spring and pin system. The spring located on the outside of the handle returns the handle back to neutral after every pull. Pulling the handle past the designed distance to turn the ball valve may damage the spring. Additionally, the pin on the inside of the handle may become damaged, or the housing around the pin or retainer points may become damaged. ABI advises taking time to familiarize the operator with how to operate the Ratcheting Valve prior to operation. The silver tab on the valve handle (**Fig 26**) will turn at 90-degree turns when pull cord is pulled indicating that the ball inside the valve has been properly turned. When the silver tab is perpendicular with the plumbing, the valve is closed. When the silver tab is parallel with the plumbing, the valve is opened.

The Ratcheting Valve handle is bolted to the valve body via a bolt. This bolt should be snug but never tight. If the bolt is tightened down fully it will prevent the spring from pulling the handle back to neutral. If the bolt is too loose then the handle will not turn properly and may cause the pin inside the handle to fall out. The bolt is factory set and should not be adjusted, unless the handle

Silver tab on valve is perpendicular to plumbing when valve is closed.



Fig 26A.

Silver tab on valve is parallel to plumbing when valve is opened.



Fig 26B.

If Algae starts to form inside the tank:

If algae starts to form inside your tank, fill the tank about 2/3 full and add 1 or 2 gallons of bleach. Let set for a couple hours then tow the trailer around to agitate the water then drain the water out the drain valve in front of the right tire. To get the remaining small amount of bleach water out of the tank, remove the drain plug at the bottom center of the tank (Item P/N 10-11032 on page 20-21) so as not to run the algae/bleach water thru the pump and valves. Rinse with fresh water before filling then shut drain valve in front of right tire and re-tighten 10-11032 plug back onto the underside of the tank.

SAFETY INSPECTION CHECK LIST:

The following items should be inspected before use:

- Check for Water leakage from tank, valves, piping, or hoses.
- Inspect hoses for any tears or damage to hoses or connectors.
- Check ratcheting valve rope on rear sprayer valve for any damage.
- Check engine for fuel or oil leakage – if found refer to engine manufacturer manual.
- Check engine for fuel level and oil level before operating the motor. Refer to engine manufacturer manual for running instructions.
- Inspect hand jack for any damage and ability to raise or lower the Water Trailer.
- Check tow receiver, safety chains, and hooks for any damage.
- Check wheels, and rims for damage. Check lugs or studs to ensure they are tight.
- Check tires for proper air pressure. Refer to PSI rating on the tire for proper air pressure.

CAUTION: Correct any discovered defects before continuing use!

1. In the event the water trailer lid gets damaged, 10-11233 LID W/BRKT: WATER TRAILER TANK, 340/550 GAL can be ordered. Use the existing hardware when replacing the lid onto the water tank.

550 Gal Parts Description

WATER TRAILER ASSEMBLY

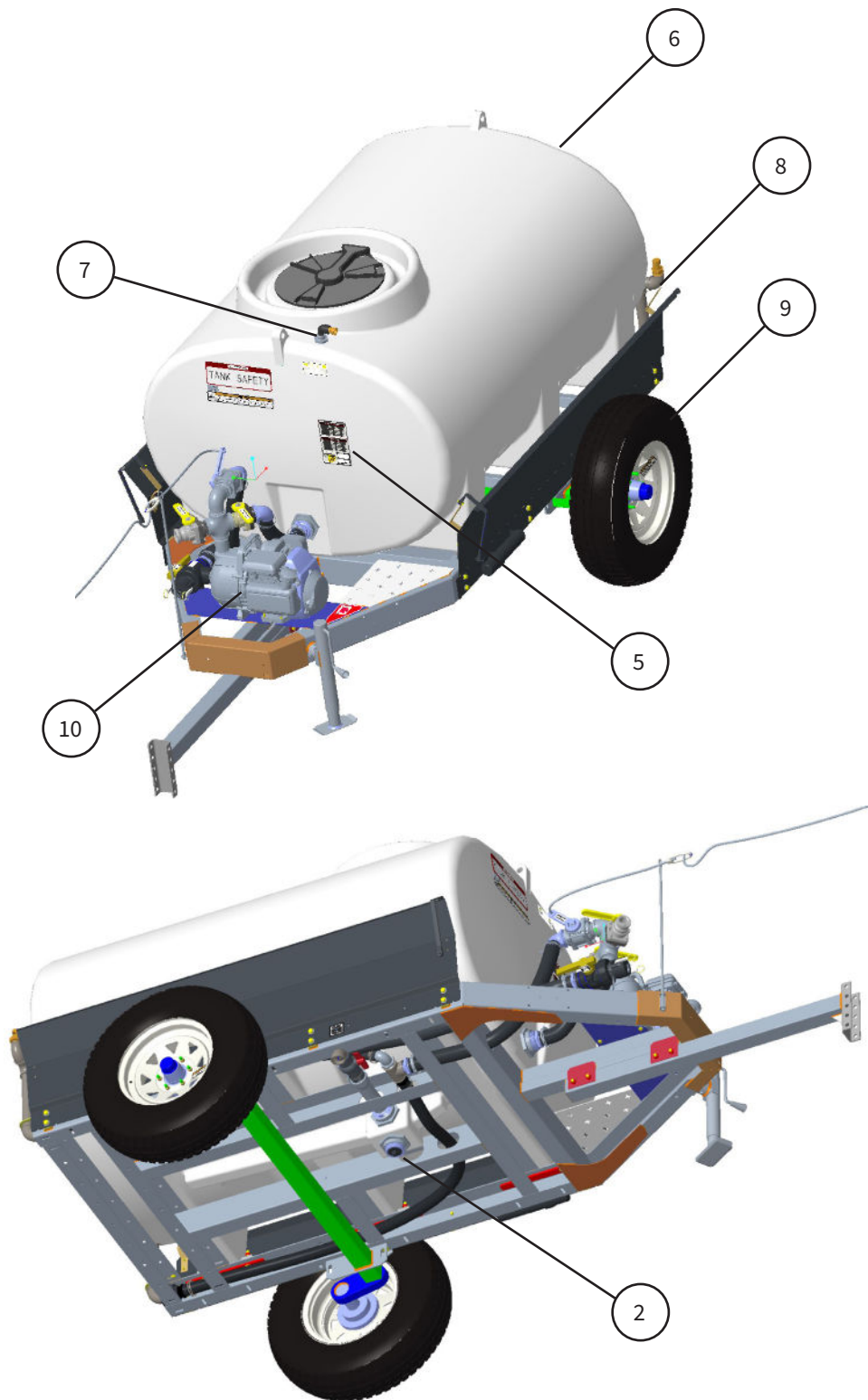

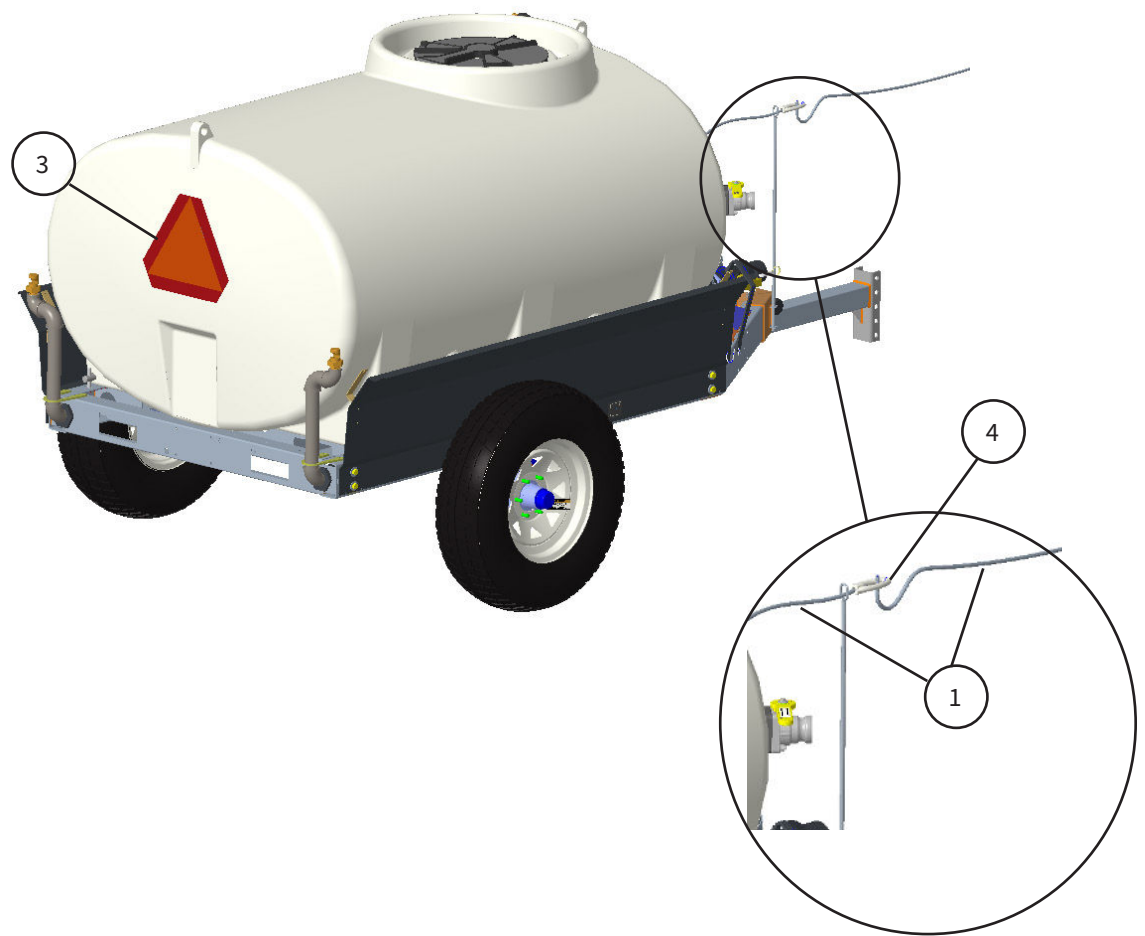

ITEM	PART #	DESCRIPTION
1	10-10126	ROPE:POLY 3/8":LEHIGH DIAMOND BRAID
2	10-11032	FITTING: 2" NPT ABS PLASTIC PLUG 3/4" DRIVE
3	10-11061	LBL: REFLECTIVE SMV SAFETY SIGN
4	10-11076	PLASTIC BREAKAWAY HONDA, 7/16" HOLE X 1/2" THK
5	10-11103	SHT: LABELS, 550 GAL WATER TRAILER
6	SEE PG 22-23	FRAME/TANK ASSEMBLY
7	SEE PG 23	GARDEN HOSE FILL ASSEMBLY
8	SEE PG 24-25	SIDE WALL ASSEMBLY (BOTH SIDES)
9	SEE PG 25	AXLE/TIRES ASSEMBLY
10	SEE PG 26-27	PUMP/PLUMBING ASSEMBLY

FRAME/TANK ASSEMBLY

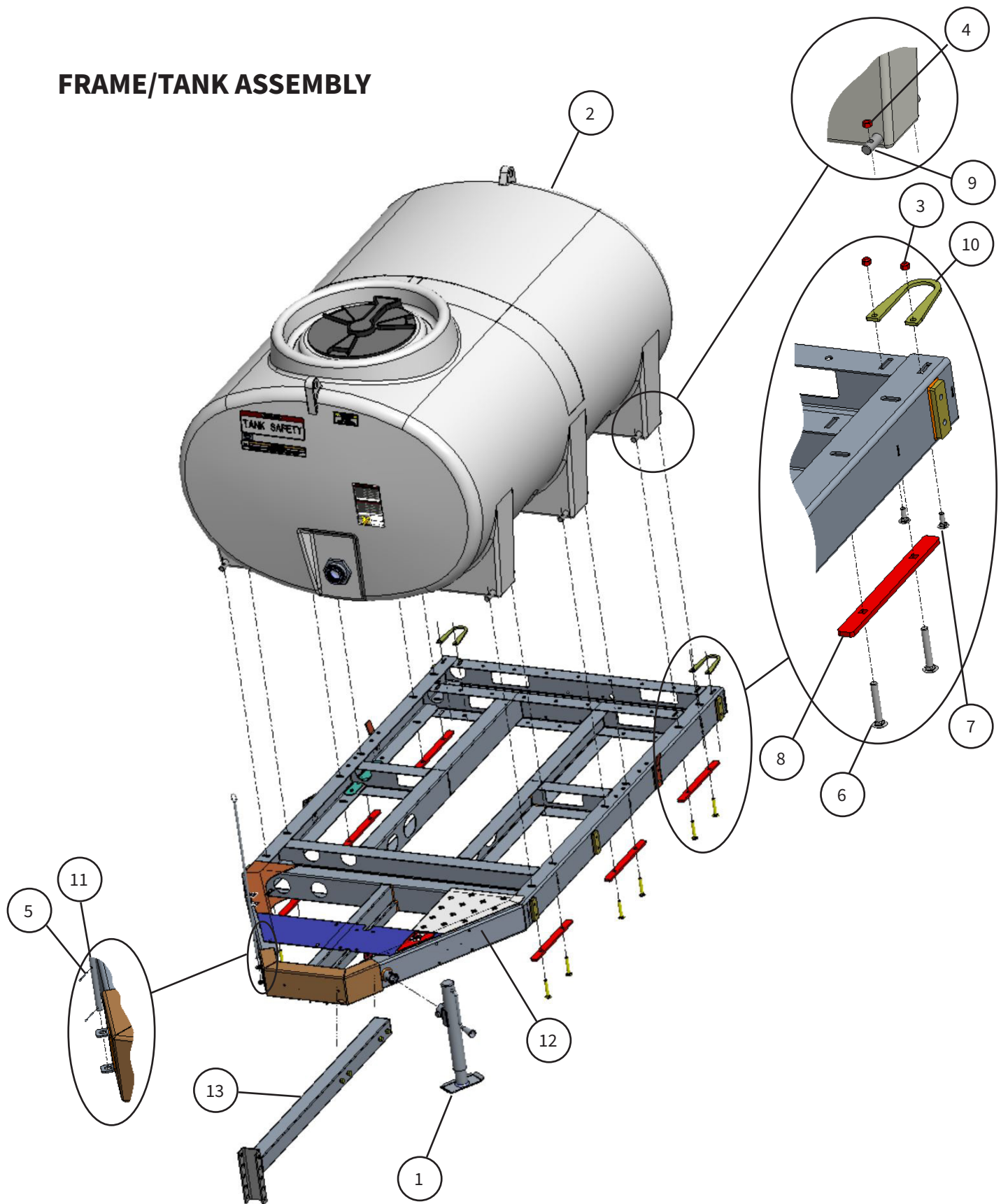

ITEM	PART #	DESCRIPTION
1	10-10075	JACK:SIDEWIND TUBULAR: WW
2	10-10972	TANK: 550 GAL LEG TANK WHITE W/ FITTINGS
3	10-20055	NYLOCK NUT:3/8-16: ZINC GR5
4	10-20201	NYLOCK NUT:1/2-13: ZINC GR 5
5	10-20227	COTTER PIN:
6	10-20304	CARR BOLT:1/2-13 3.25: ZINC GR5
7	10-20379	CARR BOLT:3/8-16 1.00": ZINC GR5
8	10-32081	PLATE: WW CARRIAGE WASHER
9	10-32082	PIN: TANK HOLD-DOWN Ø15/16" X 10" W/ HOLES
10	10-32090	BRKT: WW REAR PLUMBING STABILIZER - 1.5" PIPE
11	10-40212	WLDMT: BRACE SUPPORT BRACKET: 500 WW
12	10-40518	WLDMT: WW FRMD CHANNEL FRAME
13	10-40531	WLDMT: 50" WW BOLT-ON TONGUE

GARDEN HOSE FILL ASSEMBLY

ITEM	PART #	DESCRIPTION
1	10-10184	ELBOW: 3/4" STREET 90: POLY
2	10-10185	FITTING: 3/4" DOUBLE BULKHEAD: EPDM
3	10-10186	REDUCER NIPPLE:1" X 3/4": POLY
4	10-10187	FITTING: 3/4" GARDEN HOSE: BRASS
5	10-10188	1" VALVE - FLOAT VALVE

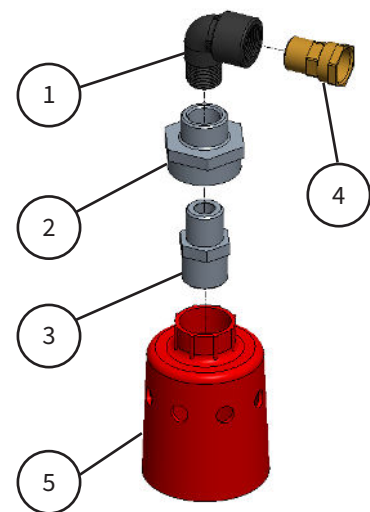

SIDE WALL ASSEMBLY (BOTH SIDES)

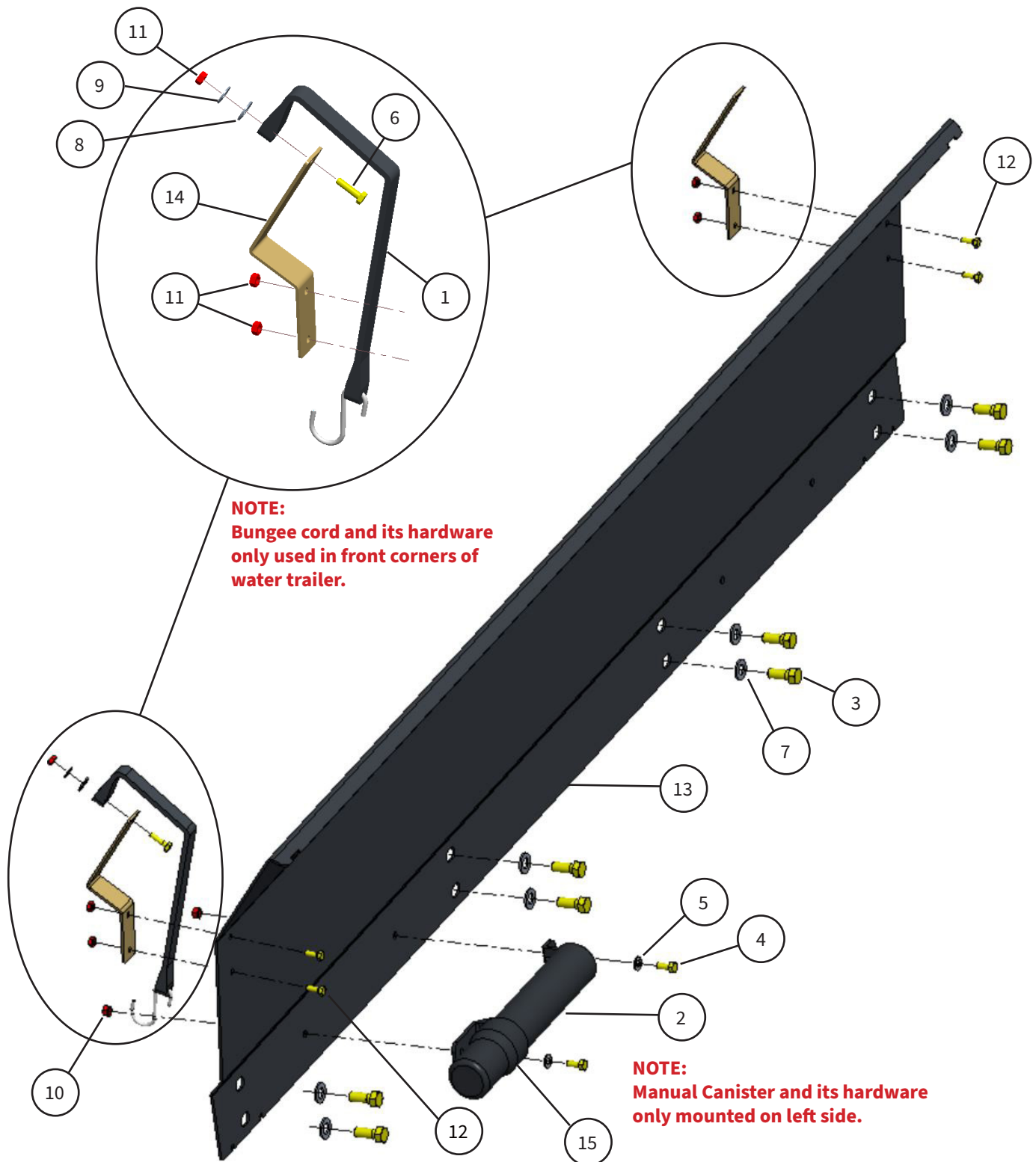

ITEM	PART #	DESCRIPTION
1	10-10165	15" Rubber Tarp Strap
2	10-10449	MANUAL CANISTER
3	10-20116	1/2-13 X 1 1/4 HEX C/S GR 5 ZNC
4	10-20117	HX HD BOLT: 5/16-18 x 3/4": ZINC GR5
5	10-20128	LT WSHR: 5/16 SAE: ZINC
6	10-20175	HX HD BOLT:1/4-20 x 1": ZINC GR5
7	10-20194	FLT WSHR:1/2 SAE: CL ZINC
8	10-20195	FLT WSHR: 3/8 SAE: ZINC
9	10-20196	FLT WSHR:1/4 SAE:CL ZINC
10	10-20202	NYLOCK NUT:5/16-18: ZINC GR 5
11	10-20208	NYLOCK NUT:1/4-20: ZINC CL
12	10-20400	HX HD BOLT: 1/4-20 .75": ZINC GR5
13	10-31878	PLATE: WW BOLT-ON SIDE SKIRT
14	10-32087	BRKT: WW SIDE PANEL HOSE BRACKET
15	10-80076	OWNERS MANUAL: 550 GALLON COMPACT WATER WAGON

AXLE/TIRES ASSEMBLY

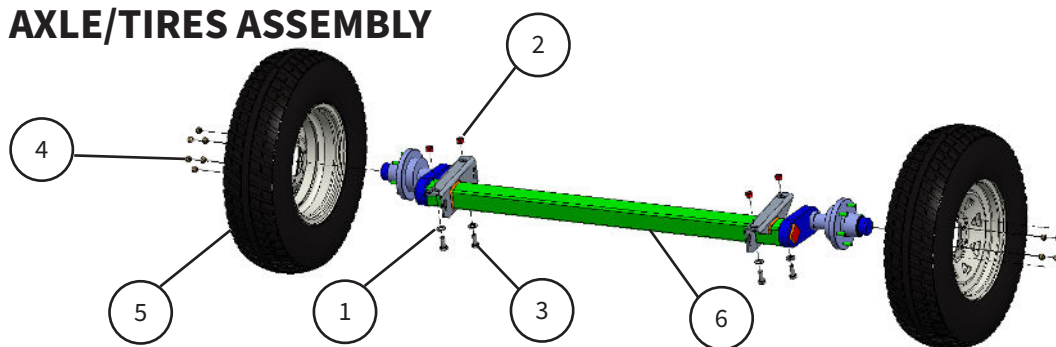

ITEM	PART #	DESCRIPTION
1	10-20145	FLT WSHR: 5/8 SAE: CL ZINC
2	10-20209	NYLOCK NUT: 5/8-11: ZINC CL
3	10-20503	HX HD BOLT: 5/8-11 X 1.5" ZINC GR5
4	10-60003	LUG NUT: 1/2"-20: ZINC
5	10-60038	WHEEL ASM: 500 COMP WW
6	10-60082	AXLE: 6K TORSION 69.5" H-F 48" BKT ID, 6 - 5.5" B.C.

PUMP/PLUMBING ASSEMBLY

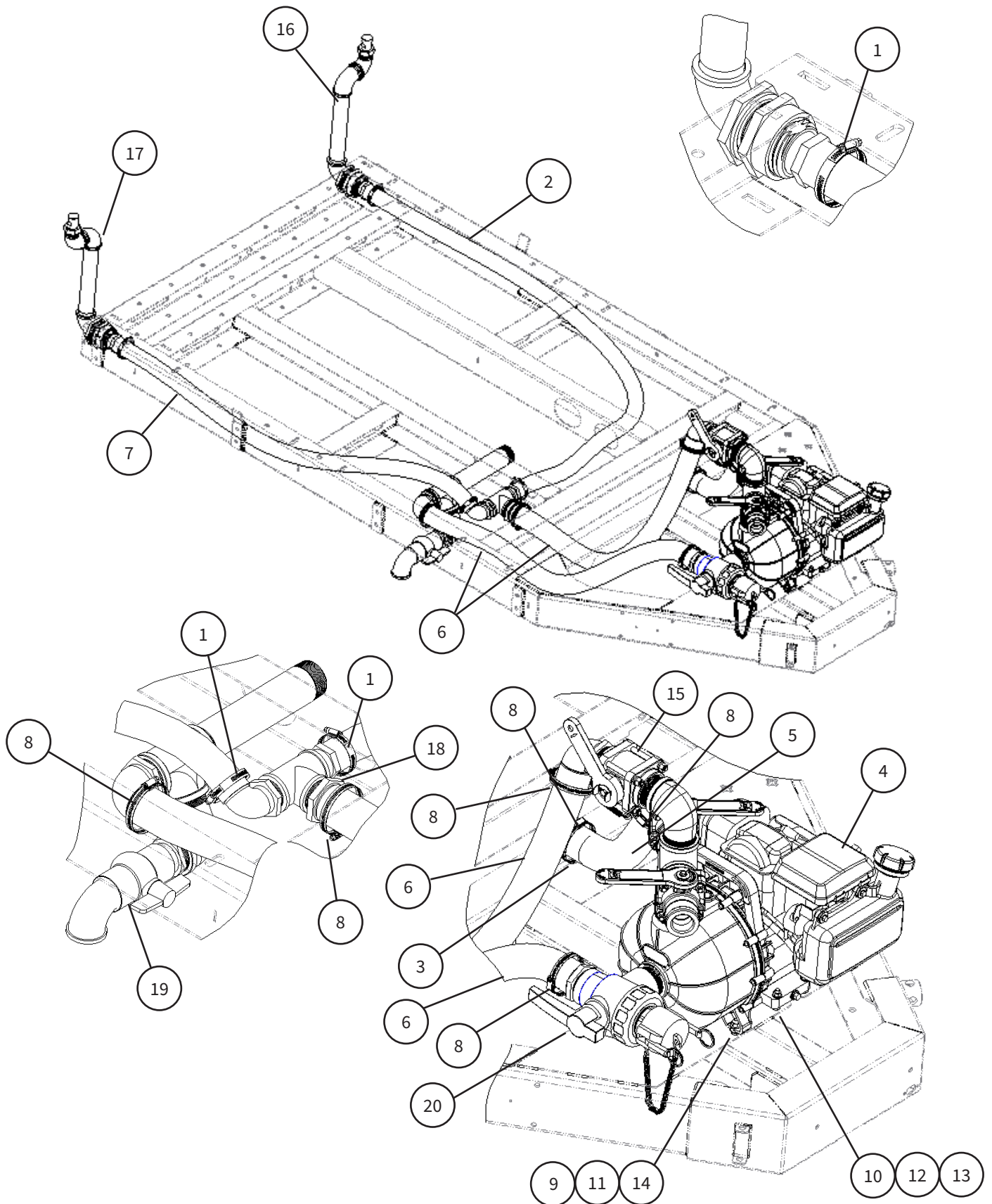

ITEM	PART #	DESCRIPTION
1	10-10101	CLAMP:1 1/2" HOSE
2	10-10530	HOSE : DOUBLE SPRAY: WW 74IN
3	10-10962	HOSE BARB: PLASTIC 2" X 2" STRAIGHT
4	10-10965	PUMP: PACER 2" W/ HONDA GC160 5.0HP
5	10-10969	HOSE: 2" EPDM 300 RE-CIRC HOSE 16" WW V2
6	10-10970	HOSE: 2" EPDM 300 SUCT/DISCH HOSE 41.5" WW V2
7	10-11030	HOSE: 1.5" EPDM 300 RIGHT DISCH. 59" WW V2
8	10-11069	CLAMP: 2" (SIZE 44) SS WORM GEAR HOSE CLAMPS
9	10-20055	NYLOCK NUT:3/8-16:ZINC GR5
10	10-20128	FLT WSHR: 5/16 SAE: ZINC
11	10-20195	FLT WSHR: 5/16 SAE: ZINC
12	10-20202	NYLOCK NUT:5/16-18:ZINC GR 5
13	10-20267	HX HD BOLT:5/16-18 1.50":ZINC GR5
14	10-20279	HX HD BOLT: 3/8-16 1.0 ZINC GR5
15	10-90564	ASM: WW V2 FRONT PLUMBING 2" W/ VALVES
16	10-90565	ASM: WW V2 REAR SPRAY PLUMB. LEFT SIDE
17	10-90566	ASM: WW V2 REAR SPRAY PLUMB. RIGHT SIDE
18	10-90567	ASM: WW V2 DISCH. FITTINGS 2" X 1.5" X 1.5" - 90°
19	10-90568	ASM: WW V2 SUCTION PLUMBING/DRAIN VALVE
20	10-90571	ASM: WW V2 SUCTION VALVE FITTINGS

10-90564

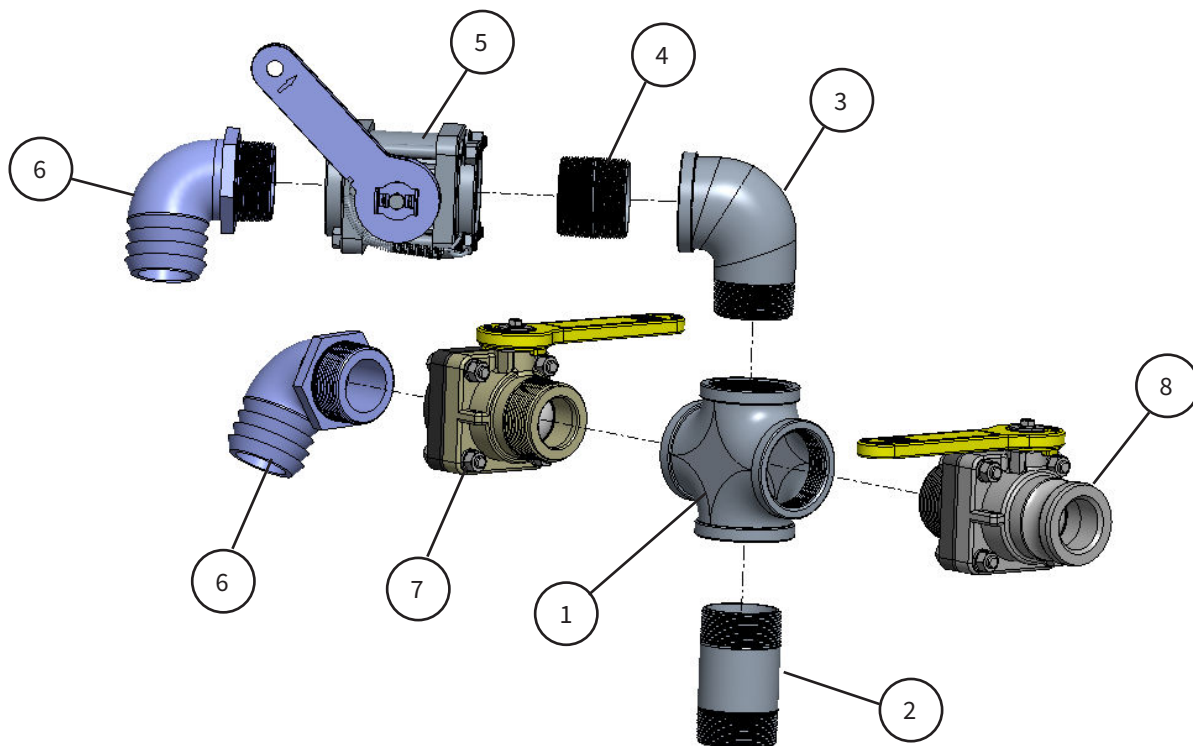

ITEM	PART #	DESCRIPTION
1	10-10957	CROSS: 2" NPT GALVANIZED CROSS FITTING
2	10-10958	NIPPLE: 2" X 4" GALVANIZED
3	10-10959	ELBOW: 2" GALVANIZED 90° STREET
4	10-10960	NIPPLE: 2" X 2" CLOSE NIPPLE GALV.
5	10-10961	VALVE: 2" NPT RACHET BALL VALVE
6	10-10975	HOSE BARB: PLASTIC 2" X 2" NPT 90°
7	10-11027	ASM: BALL VALVE: 2" NPT MALE X FEMALE W/ LONG HANDLE
8	10-11028	ASM: BALL VALVE: 2" NPT MALE X 2" CAMLOCK W/ LONG HANDLE

10-11027

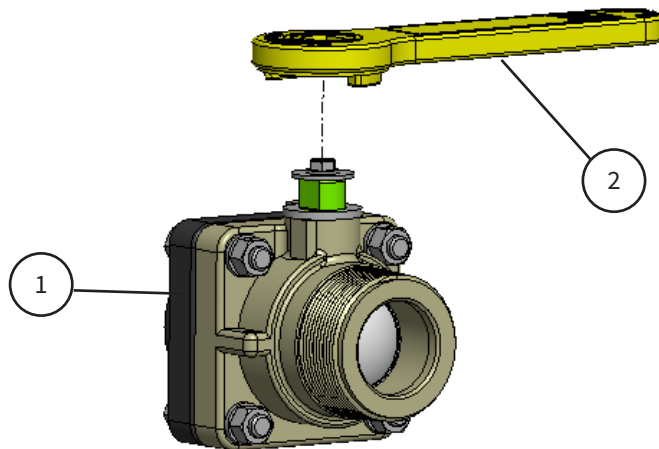

ITEM	PART #	DESCRIPTION
1	10-10963	BALL VALVE: 2" NPT FEMALE X MALE PLASTIC
2	10-11026	VALVE: TERREMAX LONG VALVE HANDLE VS25153

10-11028

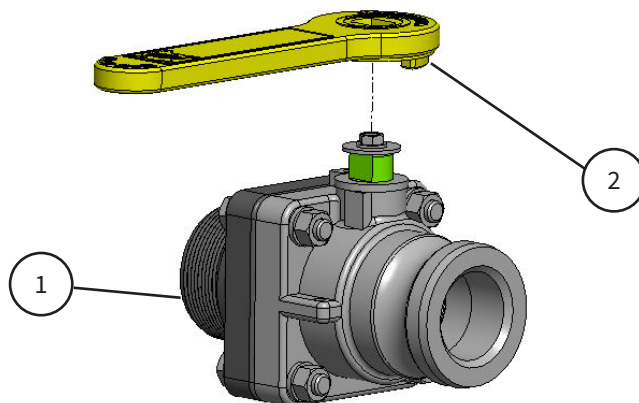

ITEM	PART #	DESCRIPTION
1	10-10967	BALL VALVE: 2" NPT MALE X CAMLOCK PLASTIC
2	10-11026	VALVE: TERREMAX LONG VALVE HANDLE VS25153

10-90565

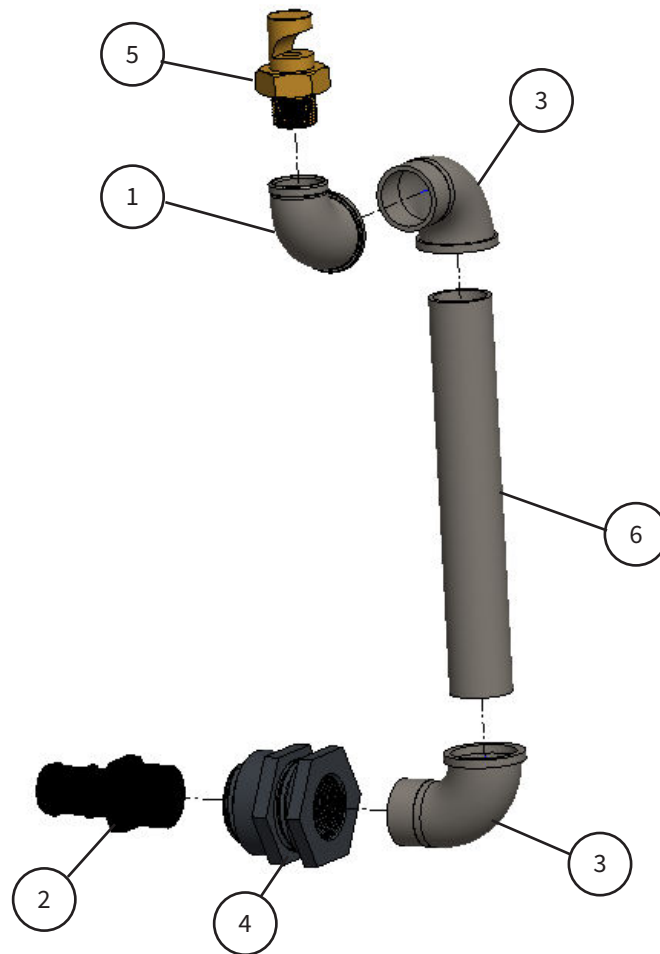

ITEM	PART #	DESCRIPTION
1	10-10100	ELBOW: 1 1/2"-1" REDUCING: GALV
2	10-10129	ADAPTER: 1-1/2" PIPE - 1-1/2" BARB: STR
3	10-10130	ELBOW: 1 1/2" STREET: GALV
4	10-10968	FITTING: 1-1/2" PLASTIC BULKHEAD
5	10-11031	NOZZLE: 1" FLOODING NOZZLE BRASS 1FL450
6	10-30203	PIPE: 1.5 X 12" NIPPLE: GALV

10-90566

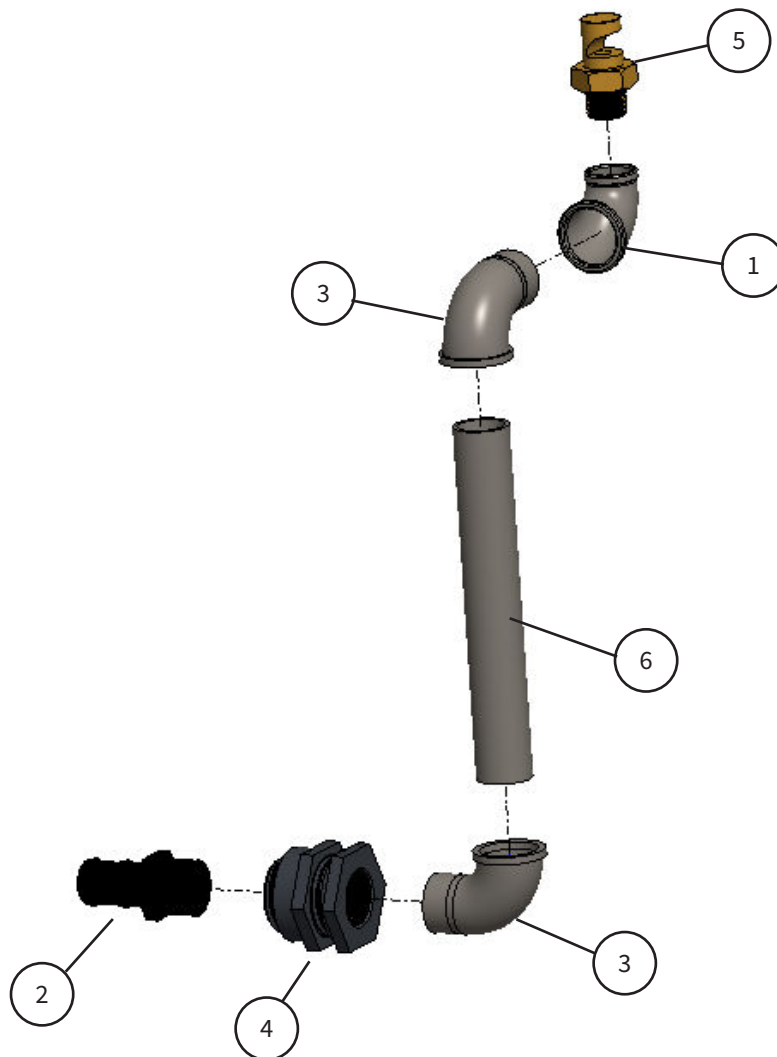

ITEM	PART #	DESCRIPTION
1	10-10100	ELBOW: 1 1/2"-1" REDUCING: GALV
2	10-10129	ADAPTER: 1-1/2" PIPE - 1-1/2" BARB: STR
3	10-10130	ELBOW: 1 1/2" STREET: GALV
4	10-10968	FITTING: 1-1/2" PLASTIC BULKHEAD
5	10-11031	NOZZLE: 1" FLOODING NOZZLE BRASS 1FL450
6	10-30203	PIPE: 1.5 X 12" NIPPLE: GALV

10-90567

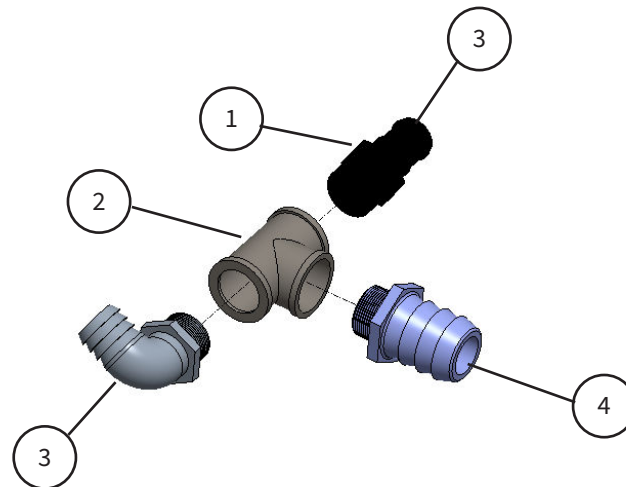

ITEM	PART #	DESCRIPTION
1	10-10129	ADAPTER: 1-1/2" PIPE - 1-1/2" BARB: STR
2	10-10173	TEE: 1 1/2" PIPE: GALV
3	10-10981	HOSE BARB: PLASTIC 1.5" X 1.5" NPT 90°
4	10-11025	HOSE BARB: 2" BARB X 1.5" MALE NPT PLASTIC

10-90568

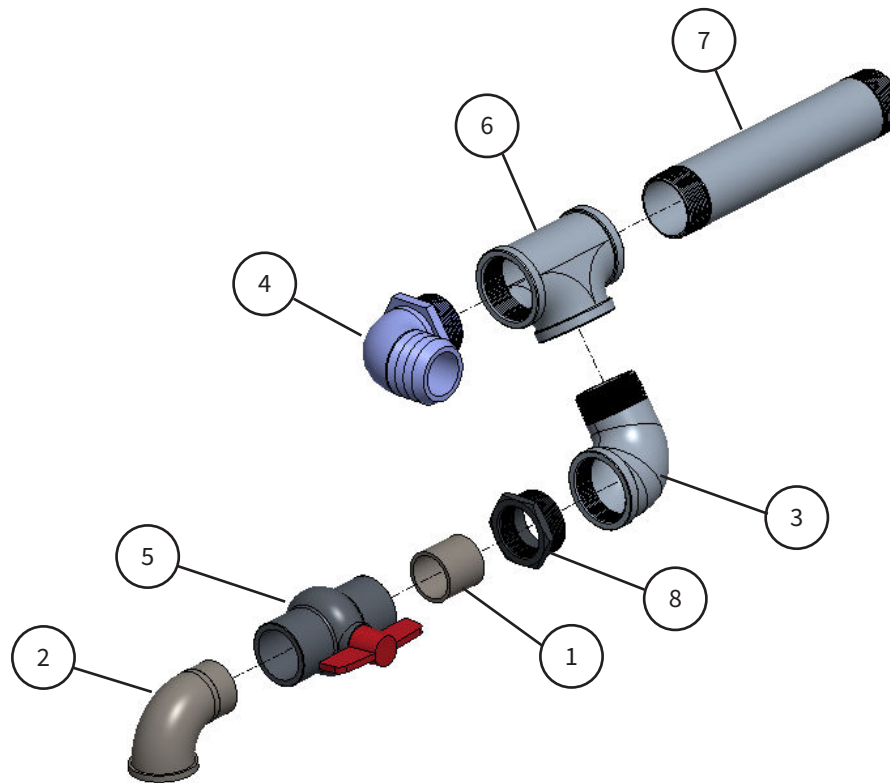

ITEM	PART #	DESCRIPTION
1	10-10124	NIPPLE: 1.5" X 1.75": GALV
2	10-10130	ELBOW: 1 1/2" STREET: GALV
3	10-10959	ELBOW: 2" GALVANIZED 90° STREET
4	10-10975	HOSE BARB: PLASTIC 2" X 2" NPT 90°
5	10-10980	BALL VALVE: 1.5" FEMALE NPT THREADED PVC
6	10-10986	TEE: 2" NPT GALVANIZED
7	10-10987	NIPPLE: 2" NPT X 11" GALVANIZED
8	10-10988	BUSHING: 2" NPT X 1.5" NPT REDUCING GALV

10-90571

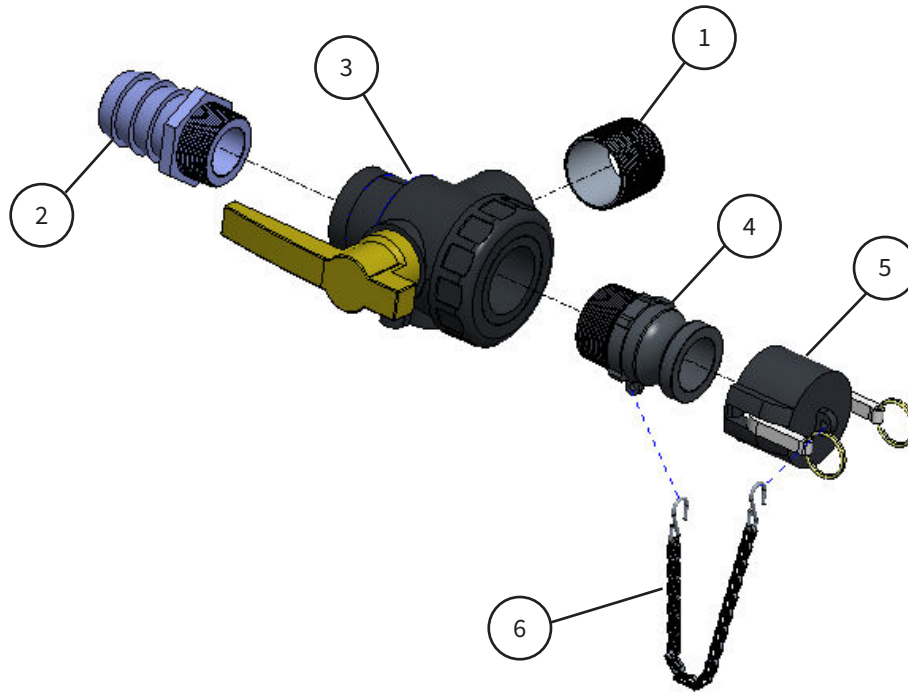

ITEM	PART #	DESCRIPTION
1	10-10960	NIPPLE: 2" X 2" CLOSE NIPPLE GALV.
2	10-10962	HOSE BARB: PLASTIC 2" X 2" STRAIGHT
3	10-10979	VALVE: 2" PLASTIC 3-WAY VALVE W/ SHUTOFF
4	10-11033	ADAPTER: 2" PLASTIC CAMLOCK TYPE "F"
5	10-11068	FITTING: 2" CAMLOCK FEMALE CAP (PART "DC") PLASTIC
6	10-11102	RETAINING CHAIN: 12" LONG W/S-HOOKS

340 Gal Parts Description

WATER TRAILER ASSEMBLY

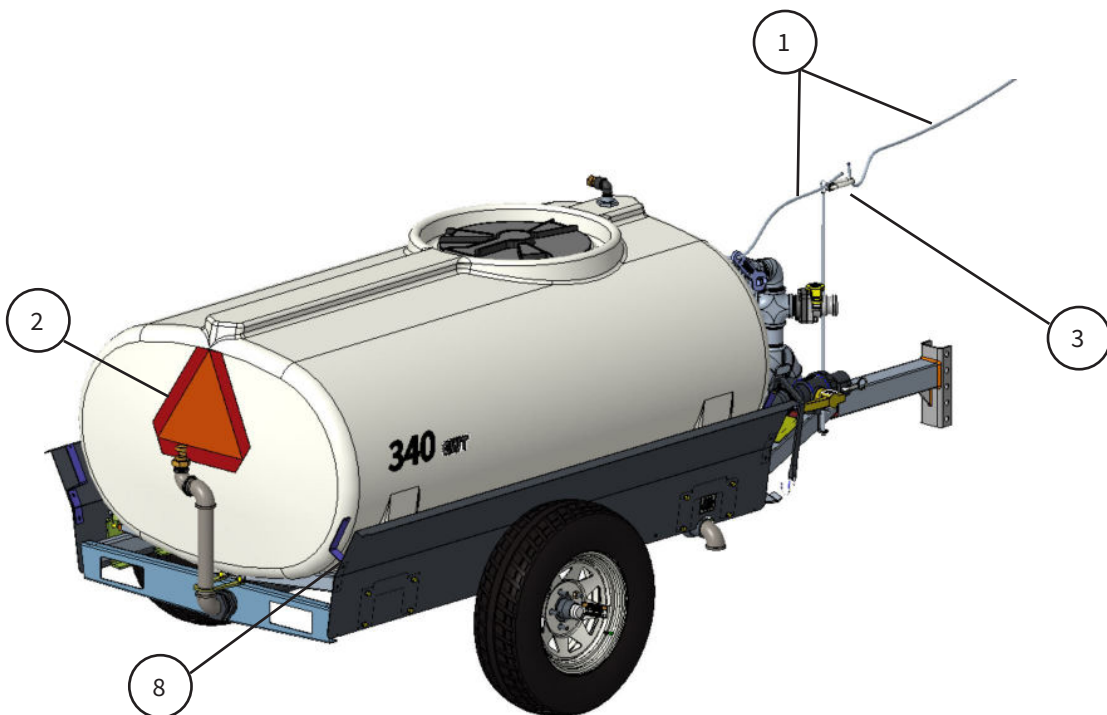

WATER TRAILER ASSEMBLY (cont'd)

ITEM	PART #	DESCRIPTION
1	10-10126	ROPE:POLY 3/8": LEHIGH DIAMOND BRAID
2	10-11061	LBL: REFLECTIVE SMV SAFETY SIGN
3	10-11076	PLASTIC BREAKAWAY HONDA, 7/16" HOLE X 1/2" THK
4	10-11114	SHT: LABELS, 340 GAL WATER TRAILER
5	SEE PG 37-38	FRAME/TANK ASSEMBLY
6	SEE PG 38	GARDEN HOSE FILL ASSEMBLY
7	SEE PG 39-40	SIDE WALL ASSEMBLY (LEFT SIDE)
8	SEE PG 41-42	SIDE WALL ASSEMBLY (RIGHT SIDE)
9	SEE PG 42	AXLE/TIRES ASSEMBLY
10	SEE PG 43-45	PUMP/PLUMBING ASSEMBLY

FRAME/TANK ASSEMBLY

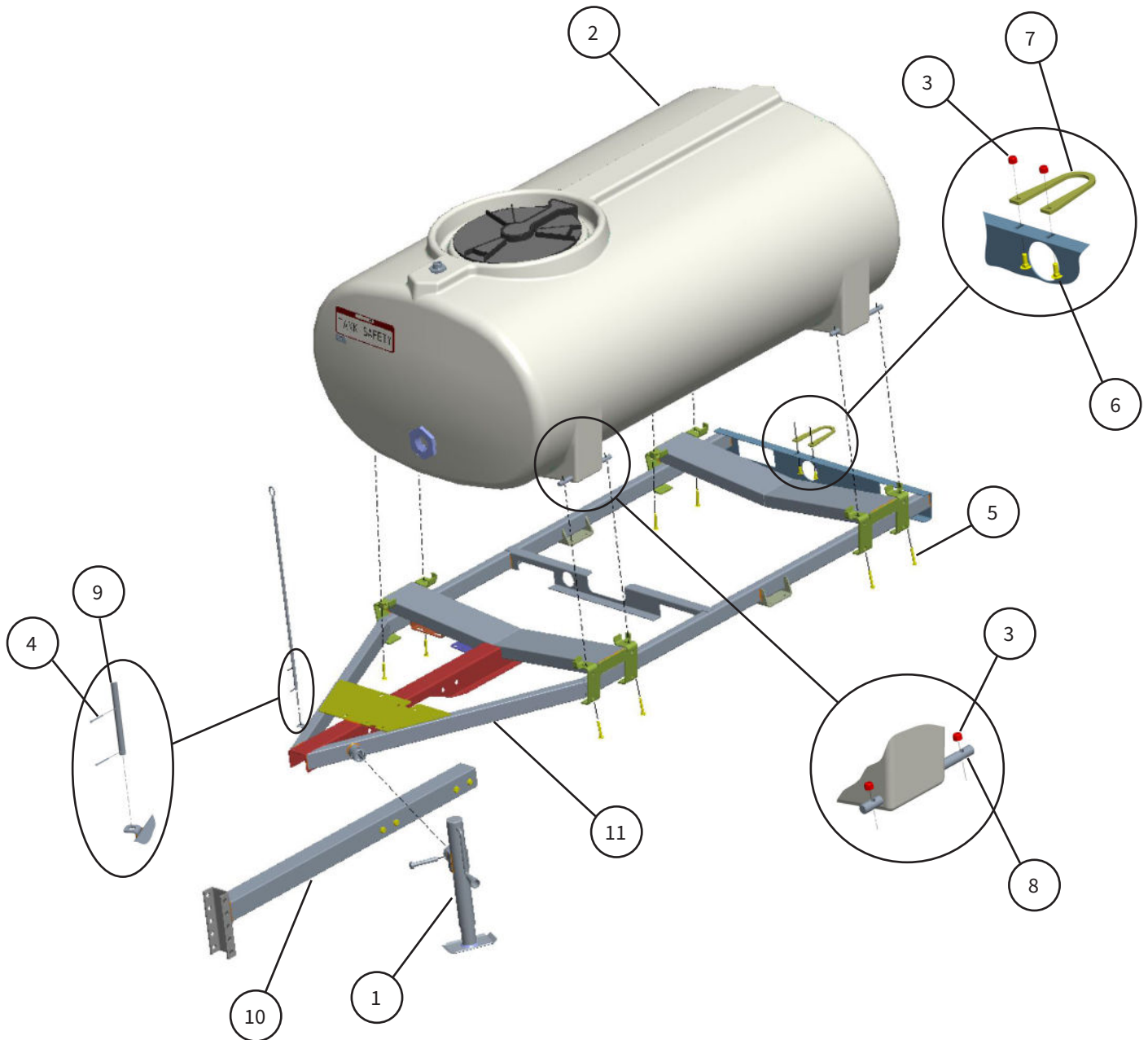

FRAME/TANK ASSEMBLY (cont'd)

ITEM	PART #	DESCRIPTION
1	10-10075	JACK:SIDEWIND TUBULAR: WW
2	10-10973	TANK: 340 GAL LEG TANK WHITE W/ FITTINGS
3	10-20055	NYLOCK NUT:3/8-16: ZINC GR5
4	10-20227	COTTER PIN: 0.09" X 1"
5	10-20330	CARR BOLT:3/8-16 2.5":ZINC GR5
6	10-20379	CARR BOLT:3/8-16 1.00": ZINC GR5
7	10-32090	BRKT: WW REAR PLUMBING STABILIZER - 1.5" PIPE
8	10-32091	PIN: TANK HOLD-DOWN Ø11/16" X 10.5" W/ HOLES
9	10-40212	WLDMT: BRACE SUPPORT BRACKET
10	10-40531	WLDMT: 50" WW BOLT-ON TONGUE
11	10-40641	WLDMT: 340WW TUBE FRAME

GARDEN HOSE FILL ASSEMBLY

ITEM	PART #	DESCRIPTION
1	10-10184	ELBOW: 3/4" STREET 90: POLY
2	10-10185	FITTING: 3/4" DOUBLE BULKHEAD: EPDM
3	10-10186	REDUCER NIPPLE:1" X 3/4": POLY
4	10-10187	FITTING: 3/4" GARDEN HOSE: BRASS
5	10-10188	1" VALVE - FLOAT VALVE

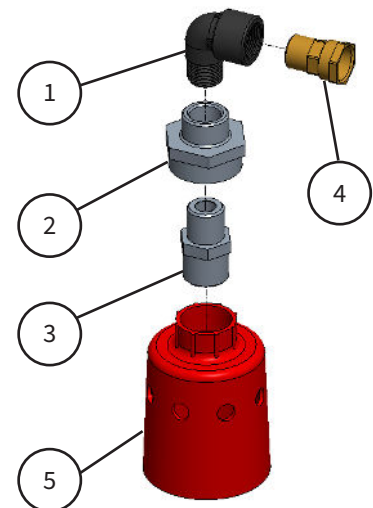

SIDE WALL ASSEMBLY - LEFT SIDE

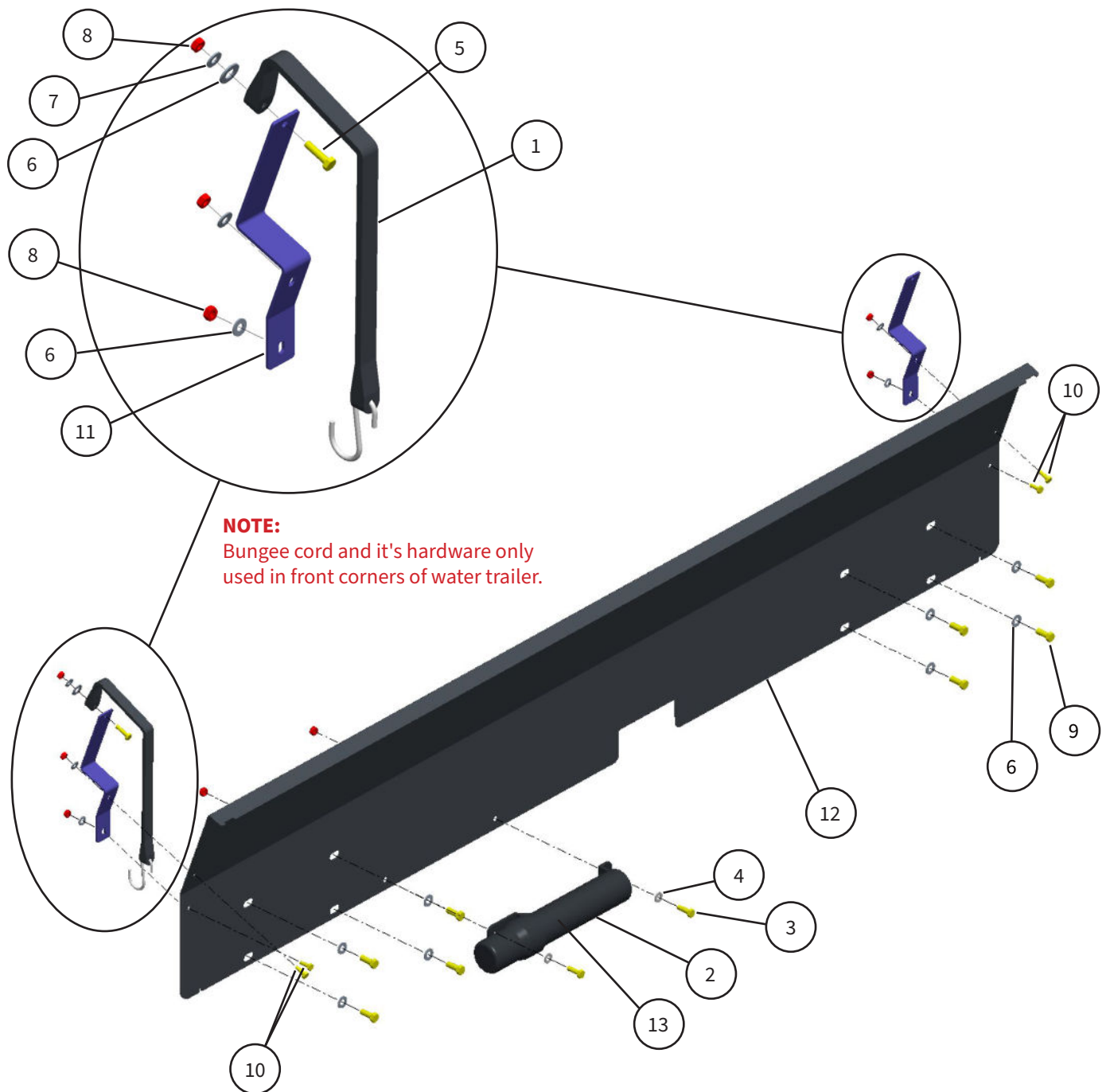

SIDE WALL ASSEMBLY - LEFT SIDE (cont'd)

ITEM	PART #	DESCRIPTION
1	10-10165	15" Rubber Tarp Strap
2	10-10449	MANUAL CANISTER
3	10-20067	HX HD BOLT: 5/16-18 x 1": ZINC GR5
4	10-20128	FLT WSHR: 5/16" SAE: ZINC
5	10-20175	HX HD BOLT: 1/4-20 x 1": ZINC GR5
6	10-20195	FLT WSHR: 3/8" SAE: ZINC
7	10-20196	FLT WSHR: 1/4" SAE: CL ZINC
8	10-20208	NYLOCK NUT: 1/4-20: ZINC CL
9	10-20279	HX HD BOLT: 3/8-16 x 1": ZINC GR5
10	10-20400	HX HD BOLT: 1/4-20 x .75": ZINC GR5
11	10-32342	BRKT: 340WW HOSE HOLDER BRACKET
12	10-32343	PLATE: 340WW BOLT-ON 14GA SIDE PANEL - LEFT
13	10-80076	ABI OWNERS MANUAL: 340/550 GALLON COMPACT WATER WAGON

SIDE WALL ASSEMBLY - RIGHT SIDE (cont'd)

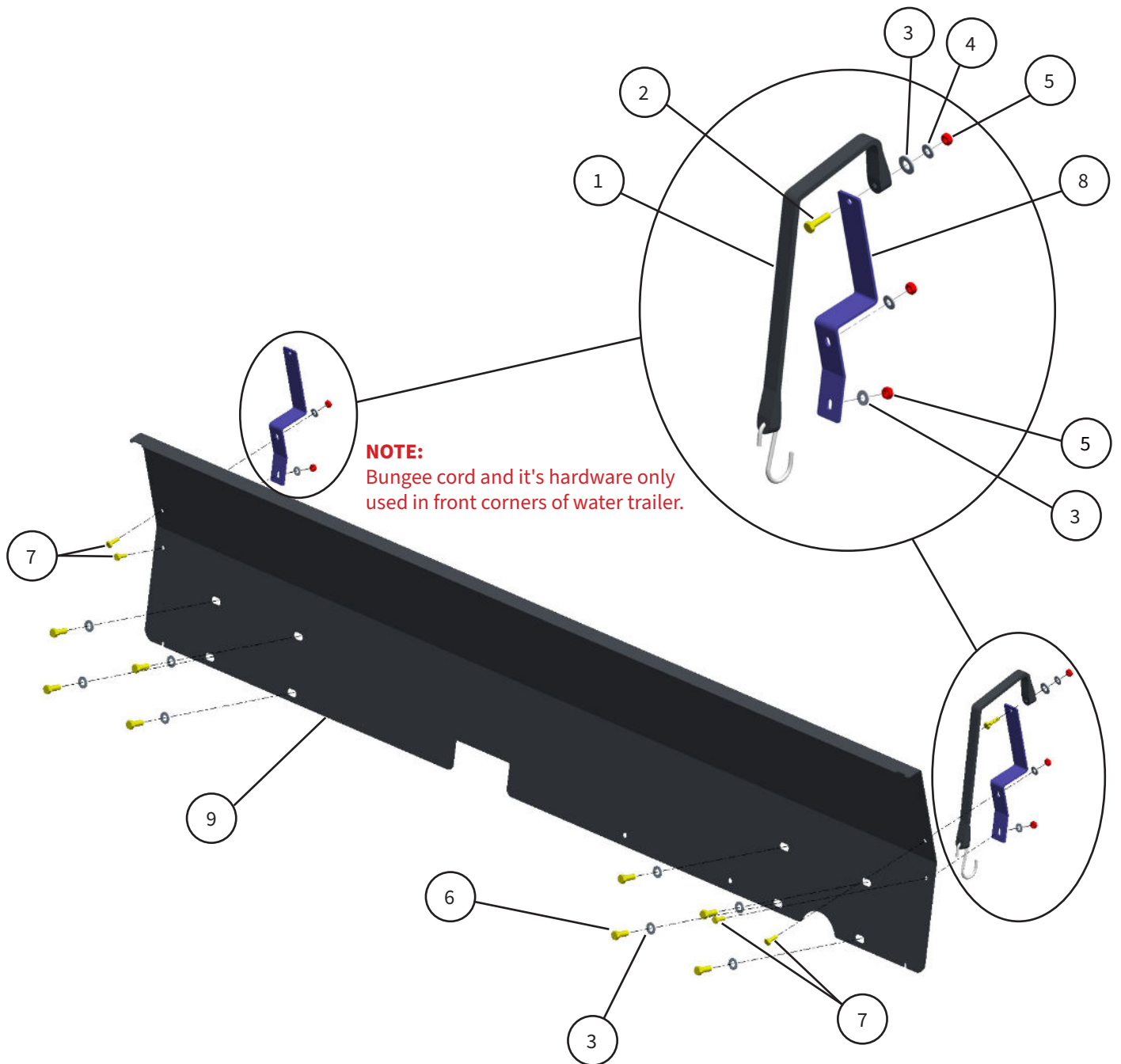

SIDE WALL ASSEMBLY - RIGHT SIDE (cont'd)

ITEM	PART #	DESCRIPTION
1	10-10165	15" Rubber Tarp Strap
2	10-20175	HX HD BOLT: 1/4-20 x 1": ZINC GR5
3	10-20195	FLT WSHR: 3/8" SAE: ZINC
4	10-20196	FLT WSHR: 1/4" SAE: CL ZINC
5	10-20208	NYLOCK NUT: 1/4-20: ZINC CL
6	10-20279	HX HD BOLT: 3/8-16 x 1": ZINC GR5
7	10-20400	HX HD BOLT: 1/4-20 x .75": ZINC GR5
8	10-32342	BRKT: 340WW HOSE HOLDER BRACKET
9	10-32344	PLATE: 340WW BOLT-ON 14GA SIDE PANEL - RIGHT

AXLE/TIRES ASSEMBLY

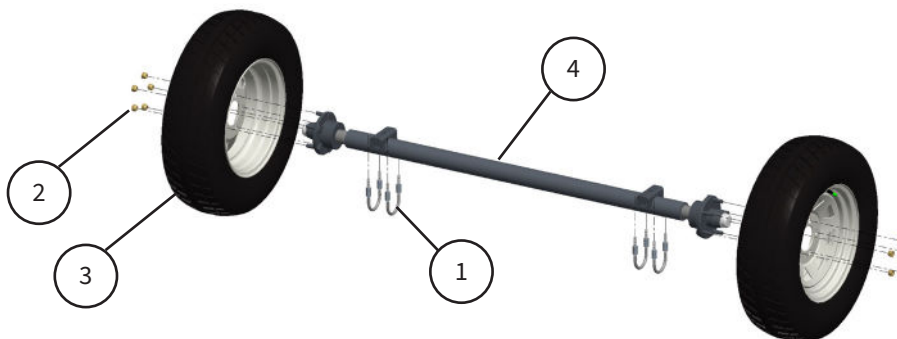

ITEM	PART #	DESCRIPTION
1	10-20488	U-BOLT: 3/8-16, 2.44 ID, 4.44 HT, 2.5 THD L, ZINC:ROUND
2	10-60003	LUG NUT: 1/2"-20: ZINC
3	10-60093	WHEEL ASM: ST205/75R14D 14X5.5, 5-4.5 B.C.
4	10-60096	AXLE: 3500-LB (NO SPRINGS) 56" HUB FACE, 38.5" S.C. 5-4.5" B.C.

PUMP/PLUMBING ASSEMBLY

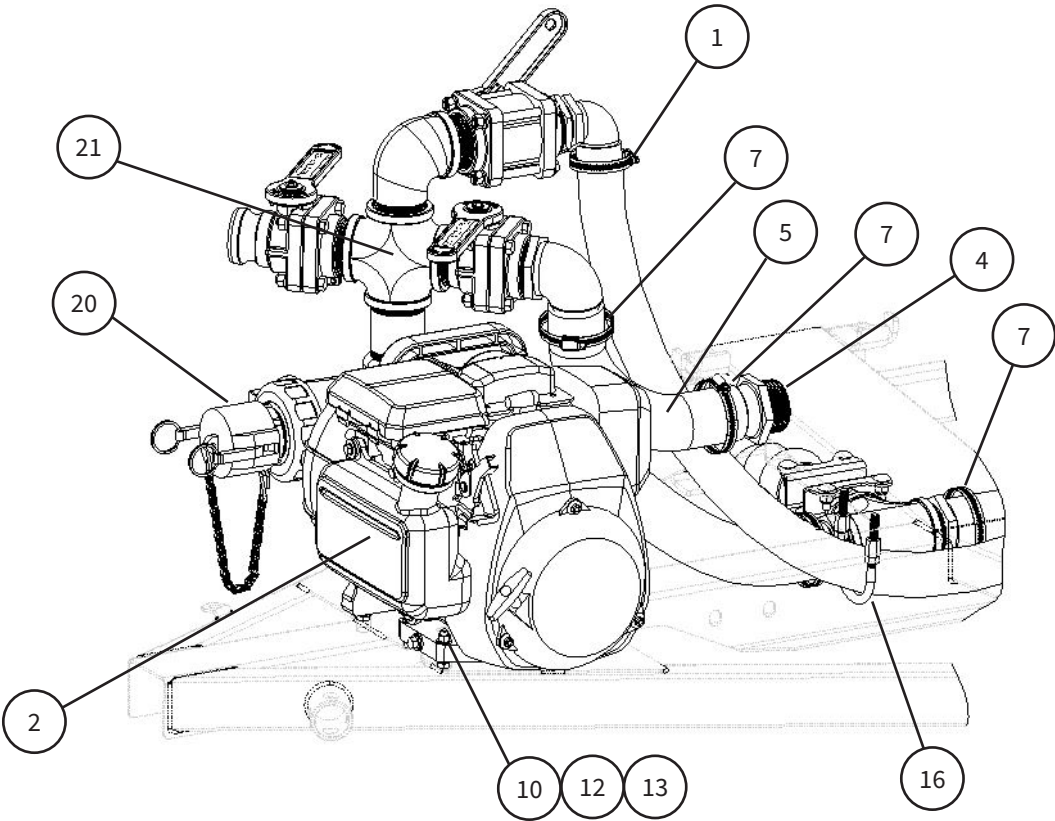
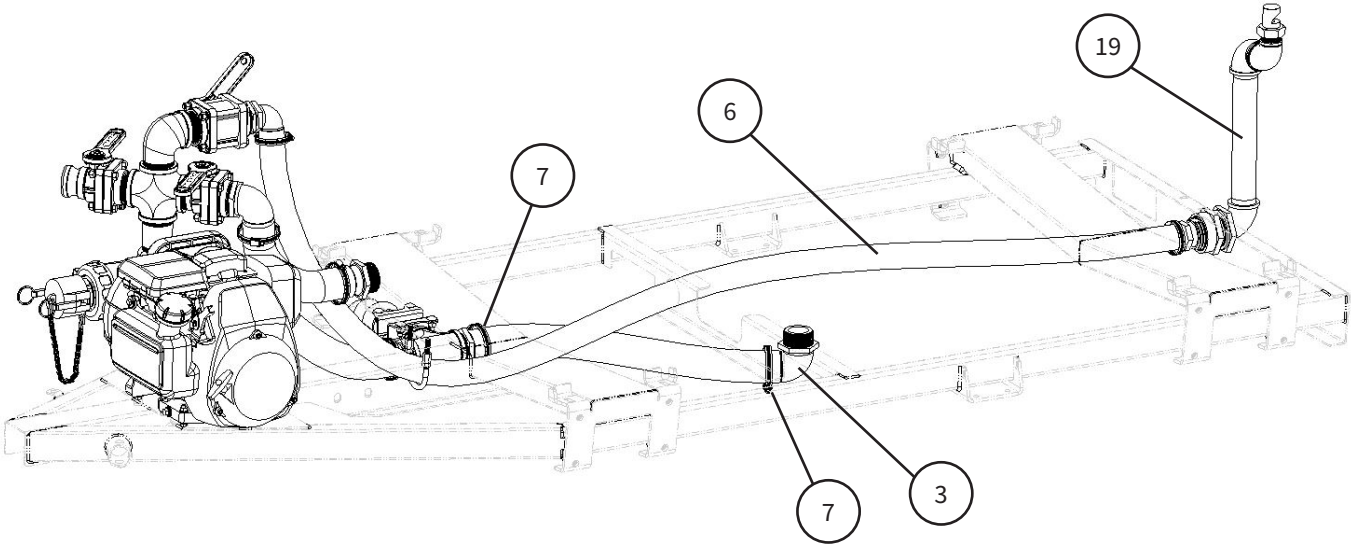

PUMP/PLUMBING ASSEMBLY (cont'd)

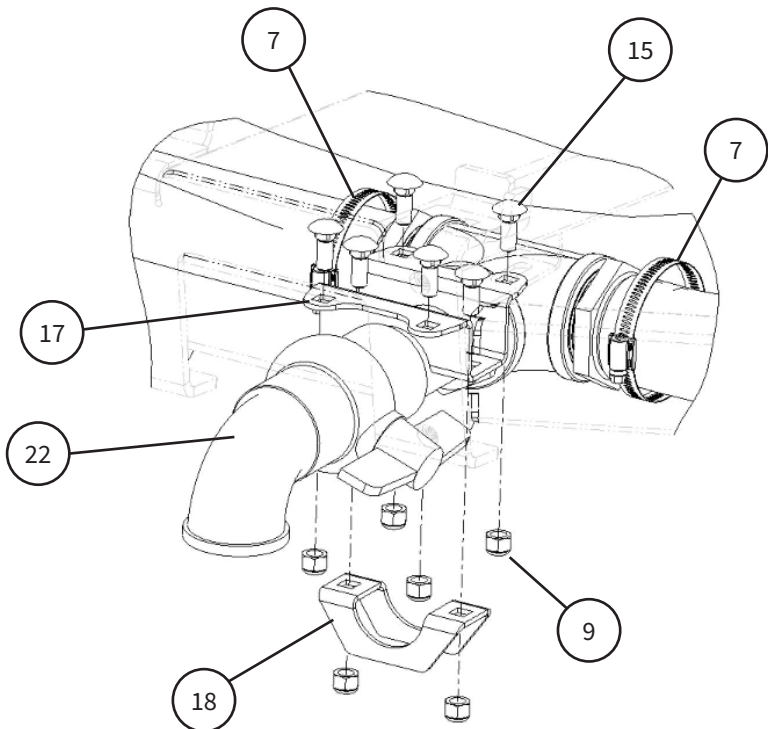
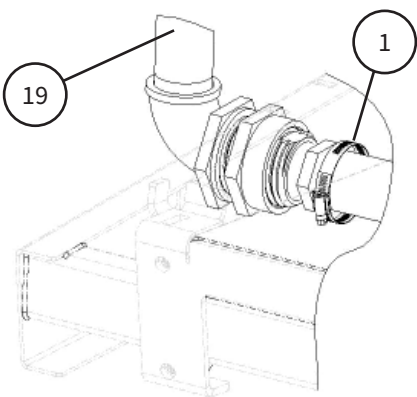
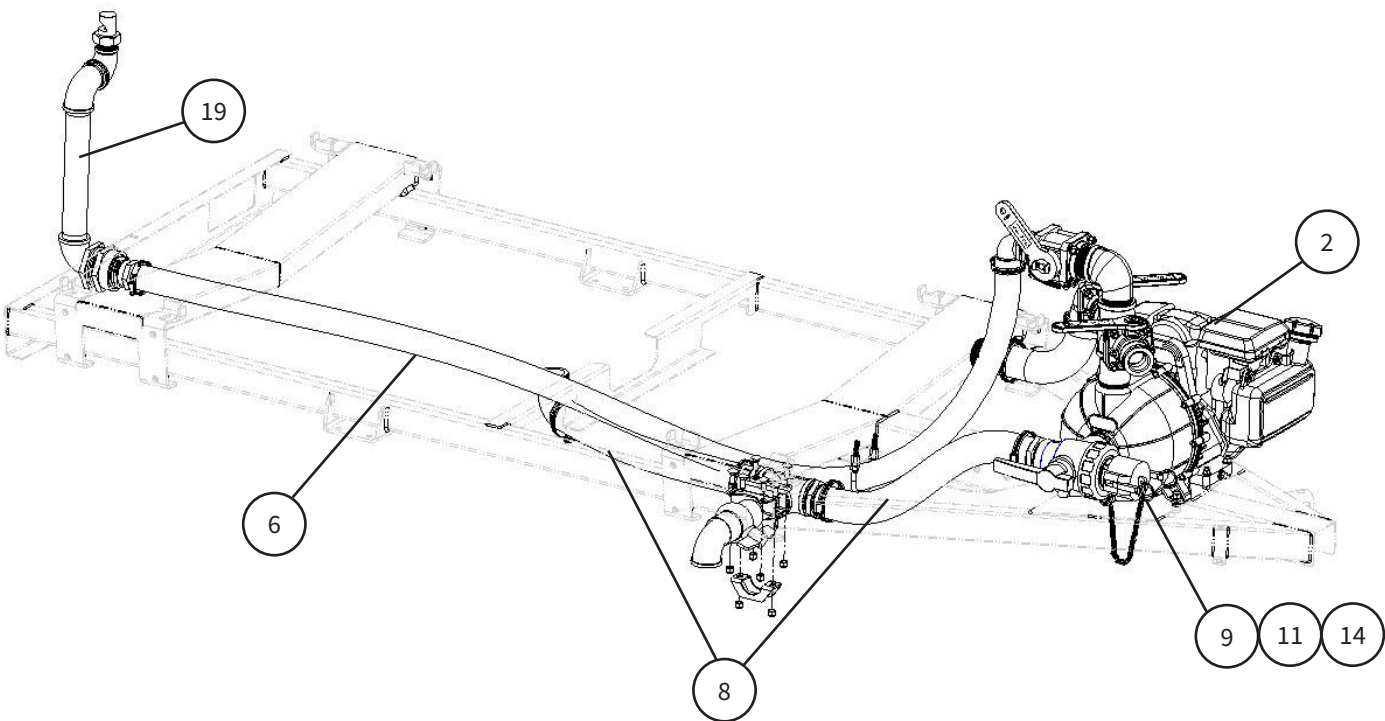

PUMP/PLUMBING ASSEMBLY (cont'd)

ITEM	PART #	DESCRIPTION
1	10-10101	CLAMP:1 1/2" HOSE
2	10-10965	PUMP: PACER 2" W/ HONDA GC160 5.0HP
3	10-10975	HOSE BARB: PLASTIC 2" X 2" NPT 90°
4	10-10962	HOSE BARB: PLASTIC 2" X 2" STRAIGHT
5	10-10969	HOSE: 2" EPDM 300 RE-CIRC HOSE 16"
6	10-11035	HOSE: 1.5" EPDM 300 DISCH HOSE 94.5"
7	10-11069	CLAMP: 2" (SIZE 44) SS WORM GEAR HOSE CLAMPS
8	10-11139	HOSE: 2" EPDM 300 TANK-SUCTION 25"
9	10-20055	NYLOCK NUT:3/8-16:ZINC GR5
10	10-20128	FLT WSHR: 5/16 SAE: ZINC
11	10-20195	FLT WSHR: 3/8 SAE: ZINC
12	10-20202	NYLOCK NUT:5/16-18:ZINC GR 5
13	10-20267	HX HD BOLT:5/16-18 1.50":ZINC GR5
14	10-20279	HX HD BOLT: 3/8-16 1.0 ZINC GR5
15	10-20379	CARR BOLT:3/8-16 1.00":ZINC GR5
16	10-20488	U-BOLT: 3/8-16, 2.44 ID, 4.44 HT, 2.5 THD L, ZINC:ROUND
17	10-32357	BRKT: 340WW DRAIN CLAMP ADAPTER
18	10-32358	BRKT: 340WW DRAIN UPPER CLAMP
19	10-90565	ASM: 340/550 WW V2 REAR SPRAY PLUMB. LEFT SIDE
20	10-90571	ASM: 340/550WW V2 SUCTION VALVE FITTINGS
21	10-90583	ASM: 340WW FRONT PLUMBING 2" W/ VALVES X 1.5" HOSE
22	10-90591	ASM: 340WW DRAIN VALVE FITTINGS

10-90583

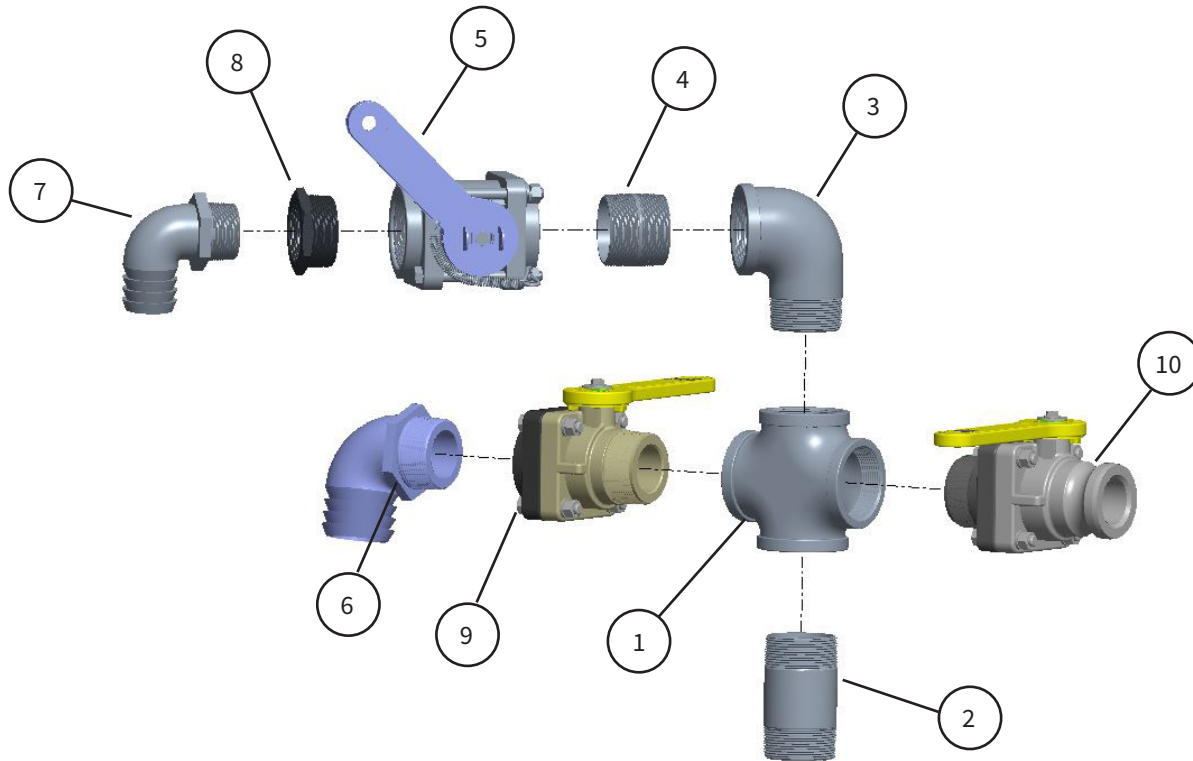

ITEM	PART #	DESCRIPTION
1	10-10957	CROSS: 2" NPT GALVANIZED CROSS FITTING
2	10-10958	NIPPLE: 2" X 4" GALVANIZED
3	10-10959	ELBOW: 2" GALVANIZED 90° STREET
4	10-10960	NIPPLE: 2" X 2" CLOSE NIPPLE GALV.
5	10-10961	VALVE: 2" NPT RACHET BALL VALVE
6	10-10975	HOSE BARB: PLASTIC 2" X 2" NPT 90°
7	10-10981	HOSE BARB: PLASTIC 1.5" X 1.5" NPT 90°: W/HEX
8	10-10988	BUSHING: 2" NPT X 1.5" NPT REDUCING GALV
9	10-11027	ASM: BALL VALVE: 2" NPT MALE X FEMALE W/ LONG HANDLE
10	10-11028	ASM: BALL VALVE: 2" NPT MALE X 2" CAMLOCK W/ LONG HANDLE

10-11027

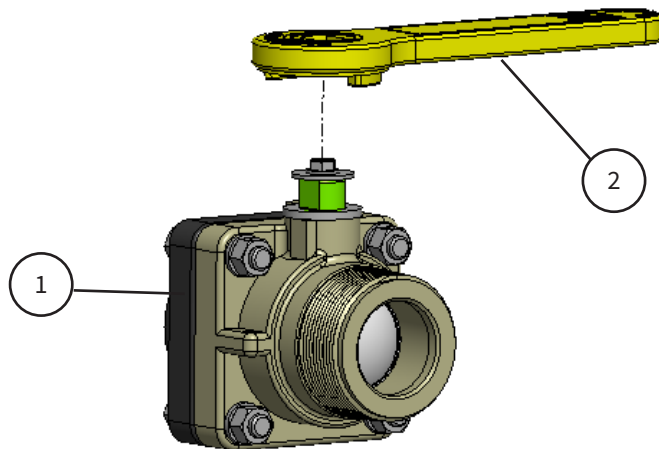

ITEM	PART #	DESCRIPTION
1	10-10963	BALL VALVE: 2" NPT FEMALE X MALE PLASTIC
2	10-11026	VALVE: TERREMAX LONG VALVE HANDLE VS25153

10-11028

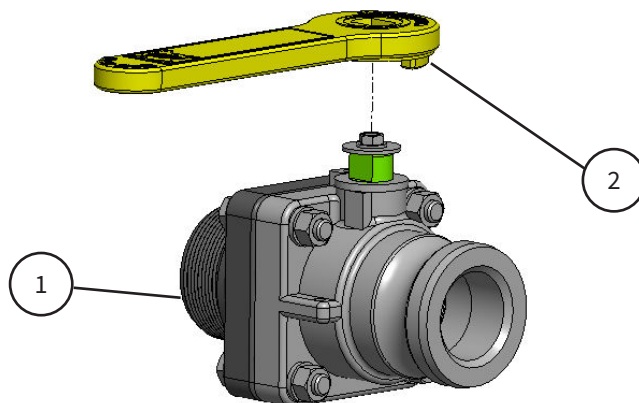

ITEM	PART #	DESCRIPTION
1	10-10967	BALL VALVE: 2" NPT MALE X CAMLOCK PLASTIC
2	10-11026	VALVE: TERREMAX LONG VALVE HANDLE VS25153

10-90565

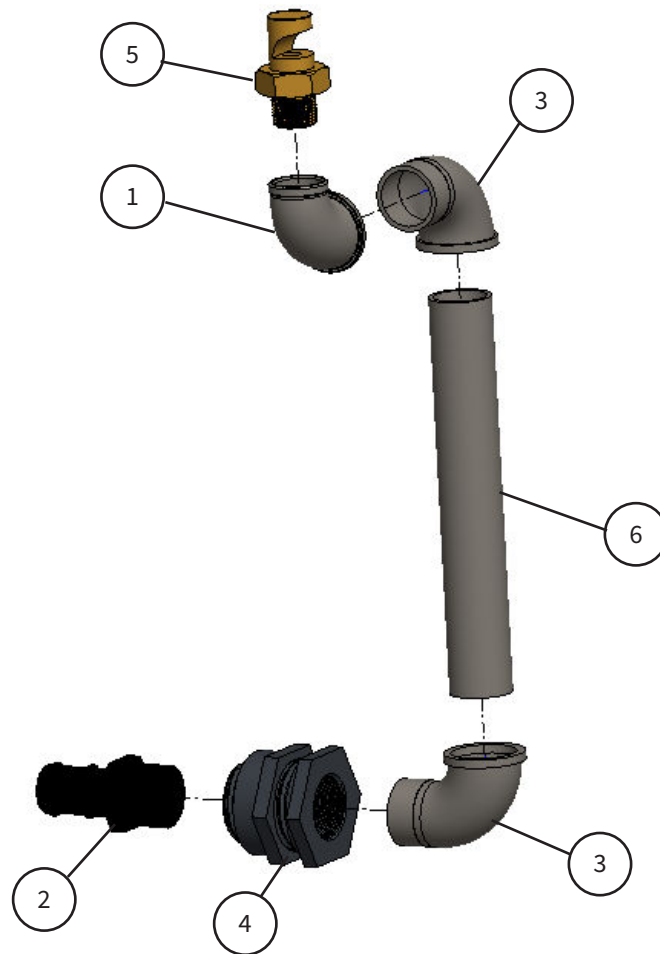

ITEM	PART #	DESCRIPTION
1	10-10100	ELBOW: 1 1/2"-1" REDUCING: GALV
2	10-10129	ADAPTER: 1-1/2" PIPE - 1-1/2" BARB: STR
3	10-10130	ELBOW: 1 1/2" STREET: GALV
4	10-10968	FITTING: 1-1/2" PLASTIC BULKHEAD
5	10-11031	NOZZLE: 1" FLOODING NOZZLE BRASS 1FL450
6	10-30203	PIPE: 1.5 X 12" NIPPLE: GALV

10-90571

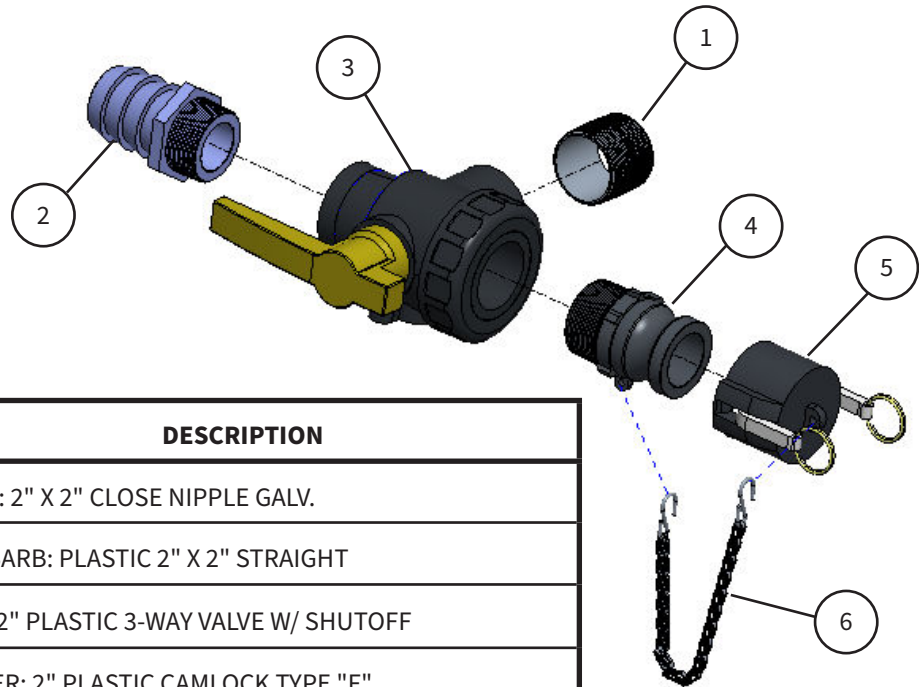

ITEM	PART #	DESCRIPTION
1	10-10960	NIPPLE: 2" X 2" CLOSE NIPPLE GALV.
2	10-10962	HOSE BARB: PLASTIC 2" X 2" STRAIGHT
3	10-10979	VALVE: 2" PLASTIC 3-WAY VALVE W/ SHUTOFF
4	10-11033	ADAPTER: 2" PLASTIC CAMLOCK TYPE "F"
5	10-11068	FITTING: 2" CAMLOCK FEMALE CAP (PART "DC") PLASTIC
6	10-11102	RETAINING CHAIN: 12" LONG W/S-HOOKS

10-90591

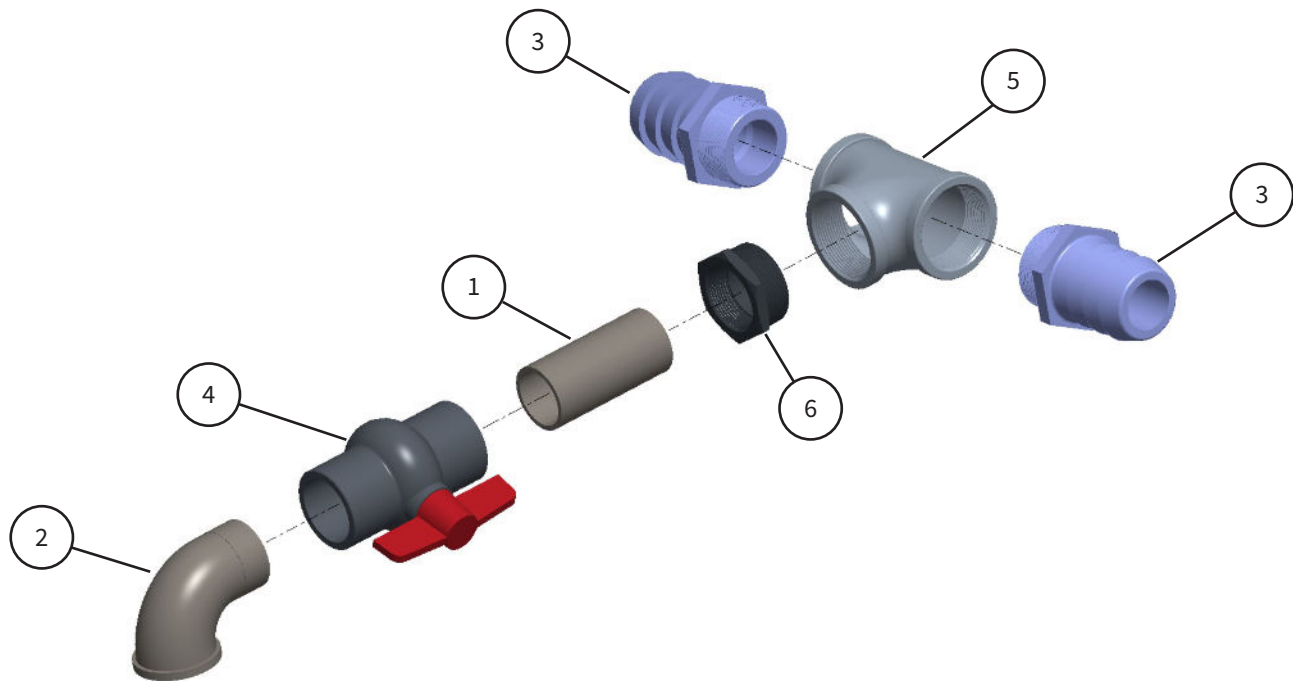

ITEM	PART #	DESCRIPTION
1	10-10122	NIPPLE:1.5" X 4"
2	10-10130	ELBOW: 1 1/2" STREET: GALV
3	10-10962	HOSE BARB: PLASTIC 2" X 2" STRAIGHT
4	10-10980	BALL VALVE: 1.5" FEMALE NPT THREADED PVC
5	10-10986	TEE: 2" NPT GALVANIZED
6	10-10988	BUSHING: 2" NPT X 1.5" NPT REDUCING GALV

Options

10-90574 Pond Fill Hose

Optional Pond Fill Hose is used to extract water from a pond (or other external water supply) to fill the water tank. Procedure to use the Pond Fill Hose is explained in the Operational Guide section on pages 11-12.



When not in use, store the Pond Fill Hose with the Spray Hose that is described in the Operational Guide section on page 13.



Wrap hose(s) around tank inside the brackets on each corner. Secure hose(s) in both front corners with bungee cords.

10-90581 Extension Hose (20ft)

Optional Extension Hose can be used to extend the Sprayer Hose reach or Hose Pond Fill reach.



10-90575 Garden Hose Adapter

Optional Garden Hose Adapter can be used in place of the Hose Sprayer when a garden hose is desired. Attach the Garden Hose Adapter to the Hose Sprayer valve in the same way as the Hose Sprayer would attach. Screw a garden hose to the fitting on the adapter and use the garden hose the same way the sprayer hose is used described in the Operational Guide section on pages 12-13.



Contact Information

ABI Attachments, Inc
520 S. Byrkit Ave.
Mishawaka, IN 46544

Customer Support

Email: support@abiattachments.com
Phone: 877-788-7253
Website: www.abisupport.com

To order parts or to speak to one of ABI's Customer Service Representatives contact us Monday to Friday 9am to 5pm EST.

The setup video for operation is available at abisupport.com under Water Trailers.

For additional information on the use or setup of the Water Trailer, please contact the ABI customer support team at 855.211.0598.

Additional support videos are available at the ABI support page (abisupport.com) under each tool.

Warranty Information and Return Policy - Warranty and return policy information can also be found on the ABI support page under each tool. For additional questions regarding warranty or return policy, contact the ABI customer support team at 855.211.0598.

